

1

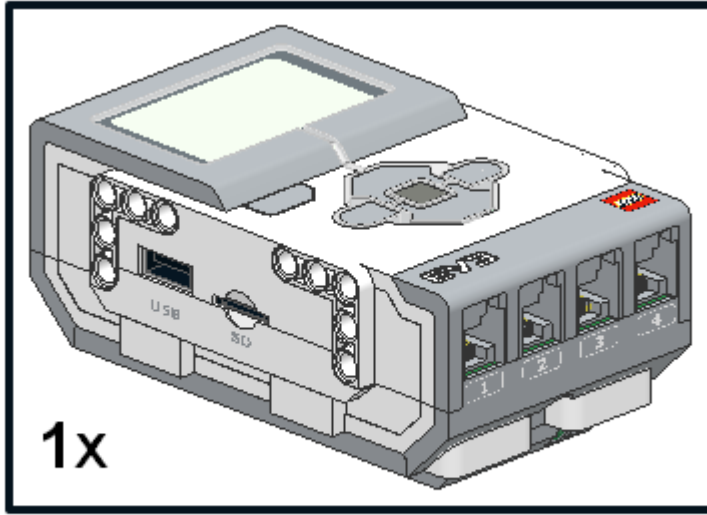

2

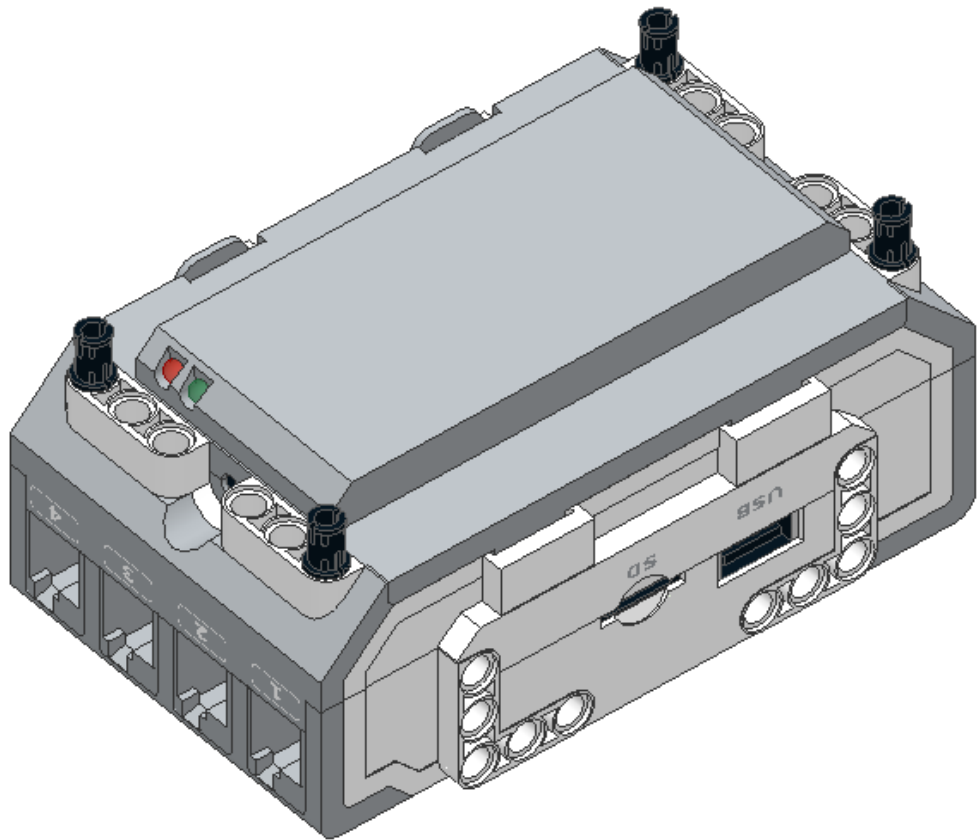

3

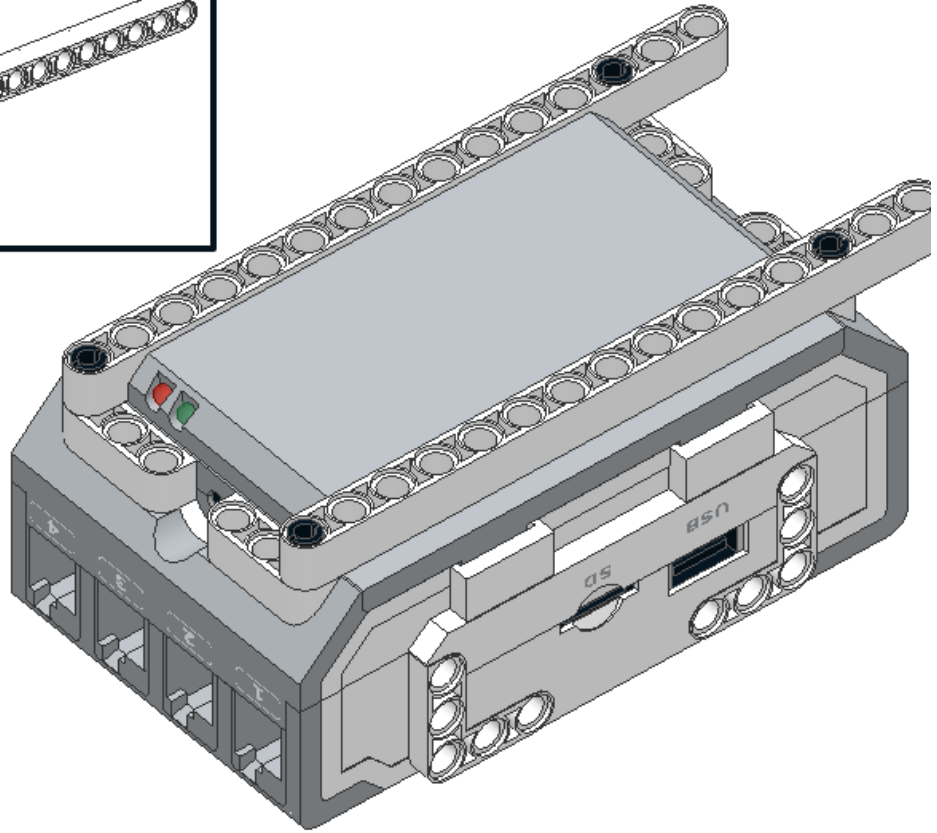
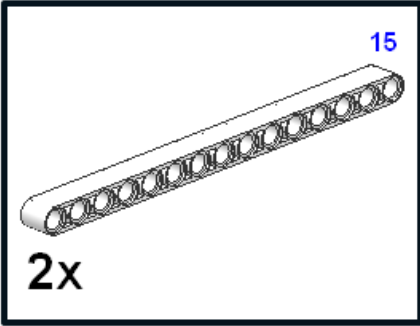

4

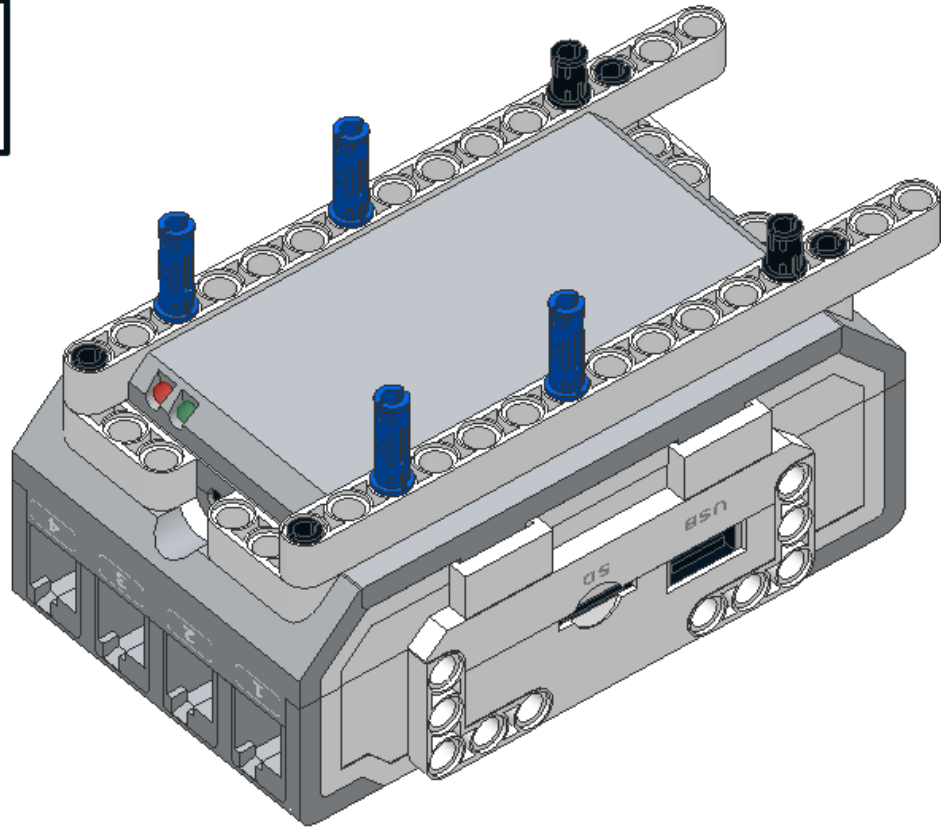
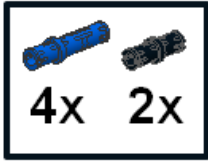

5

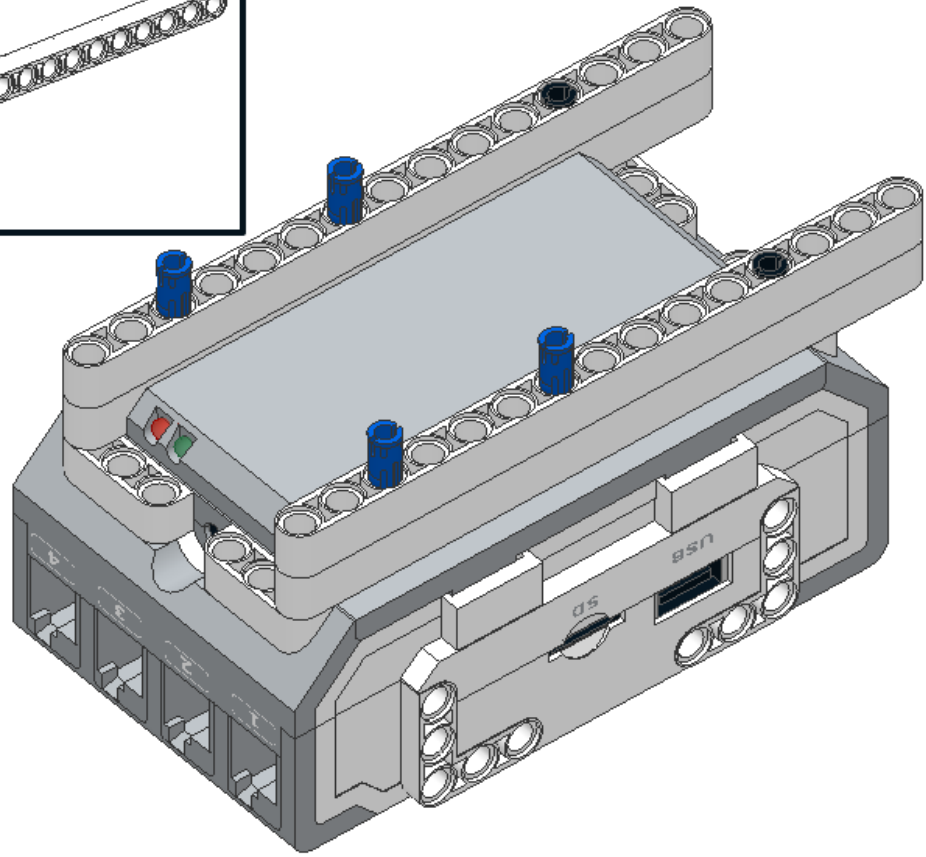
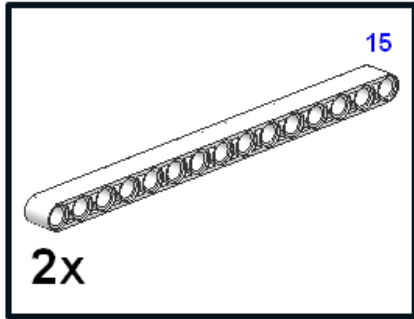

1

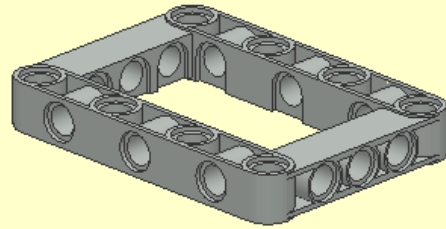
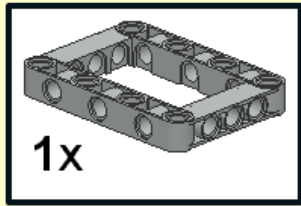

2

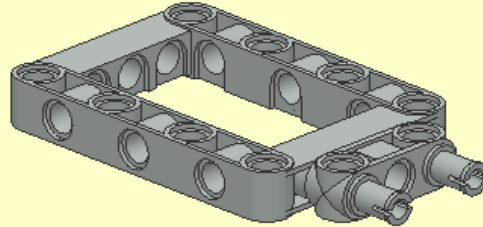
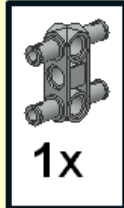

3

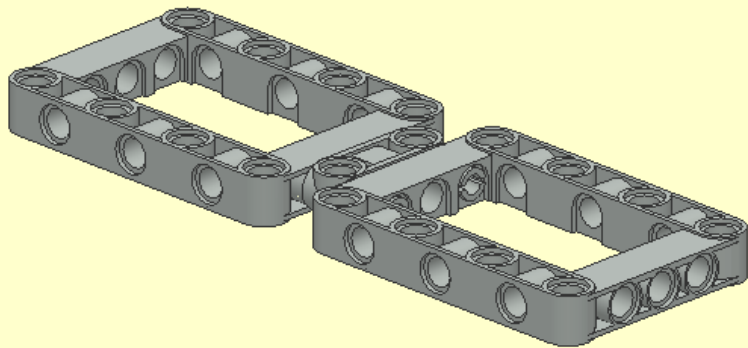
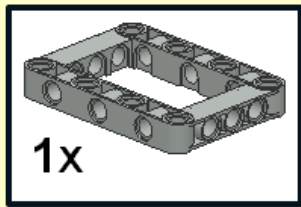

6

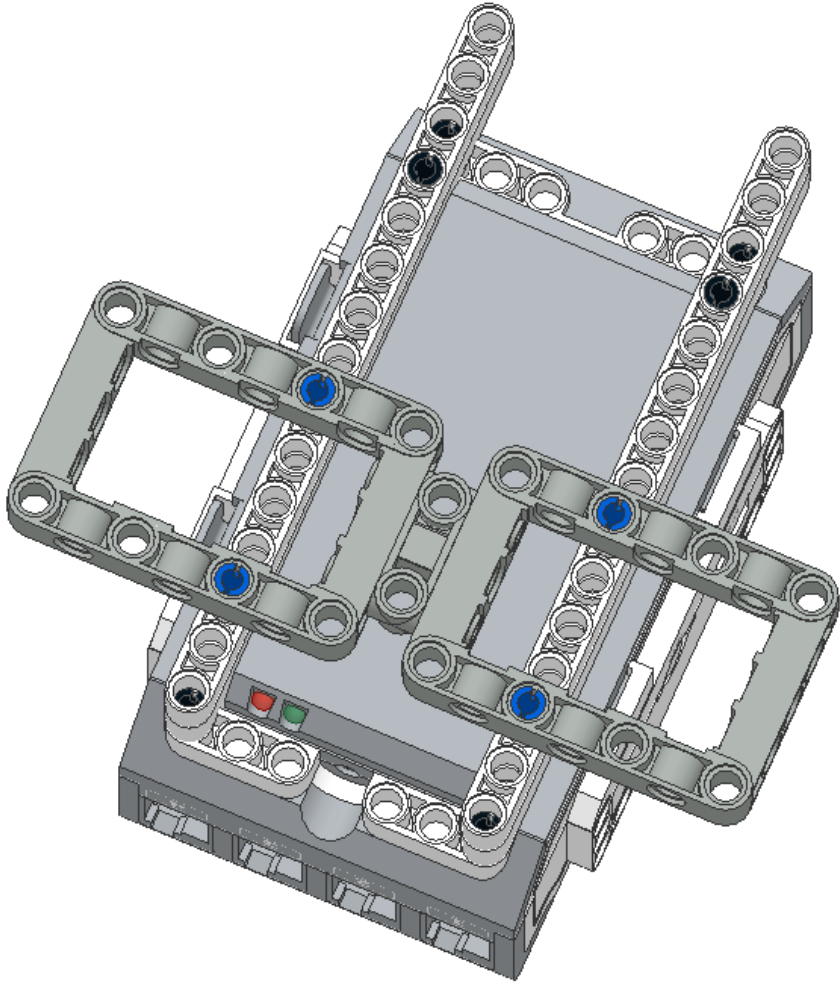

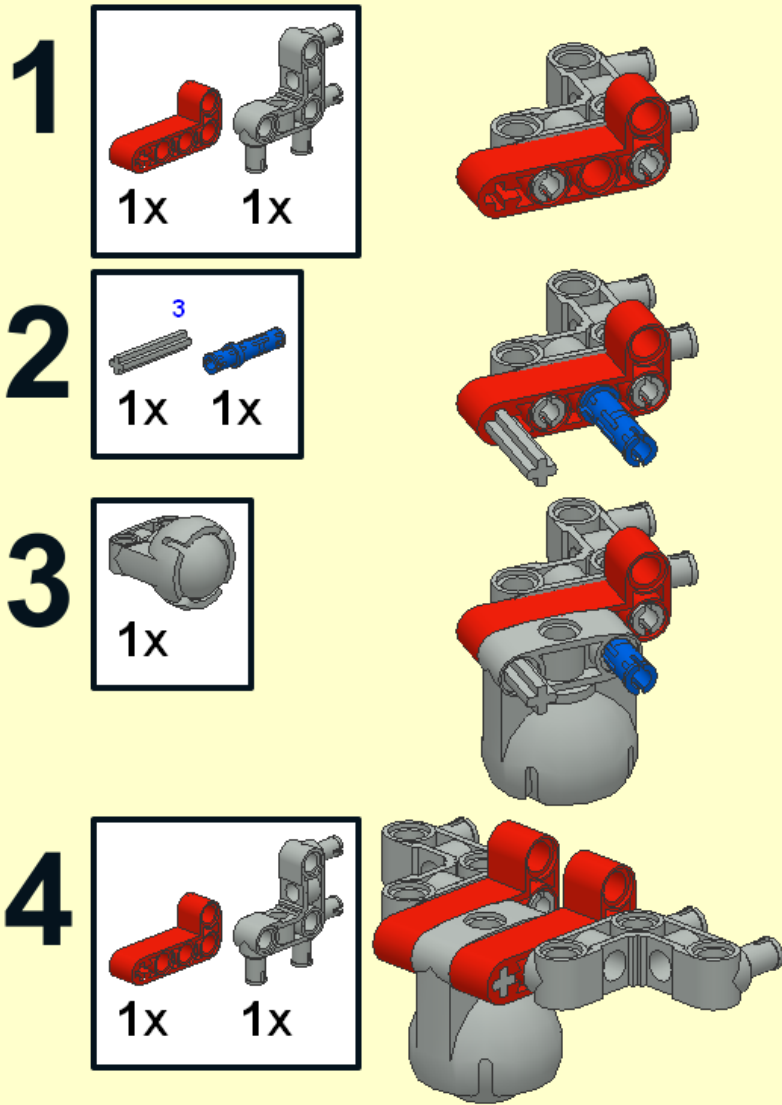

7

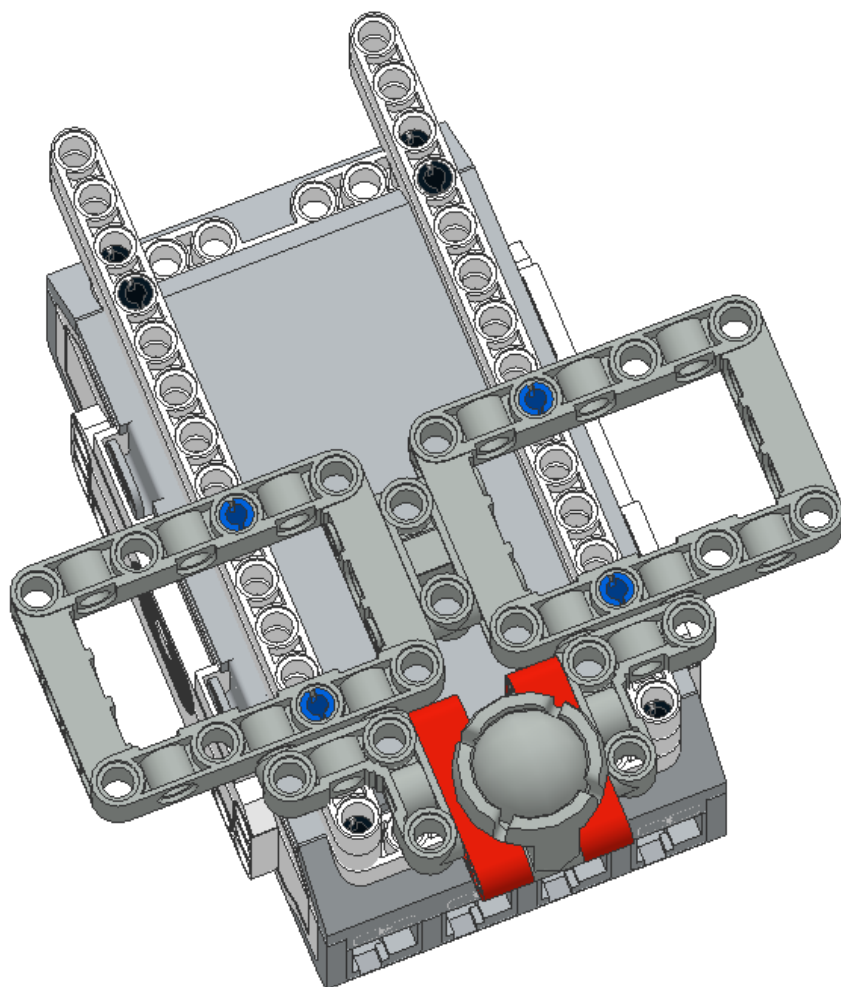

1

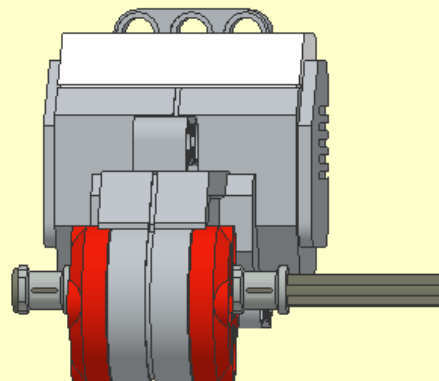
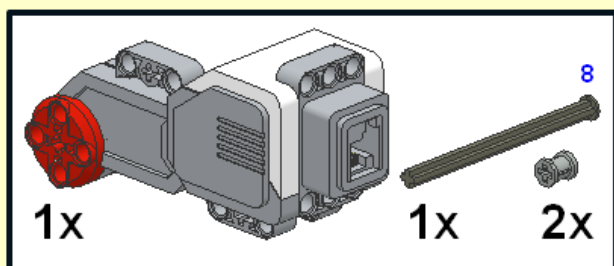

2

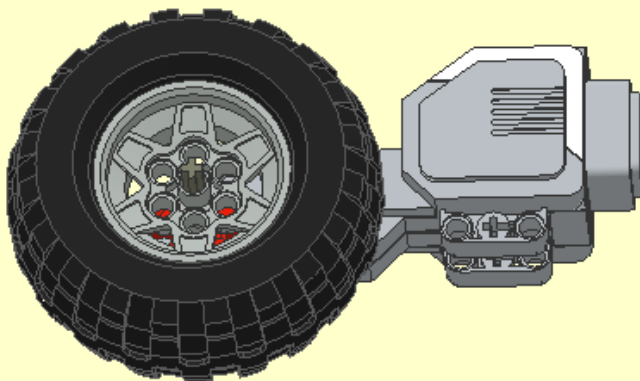

3

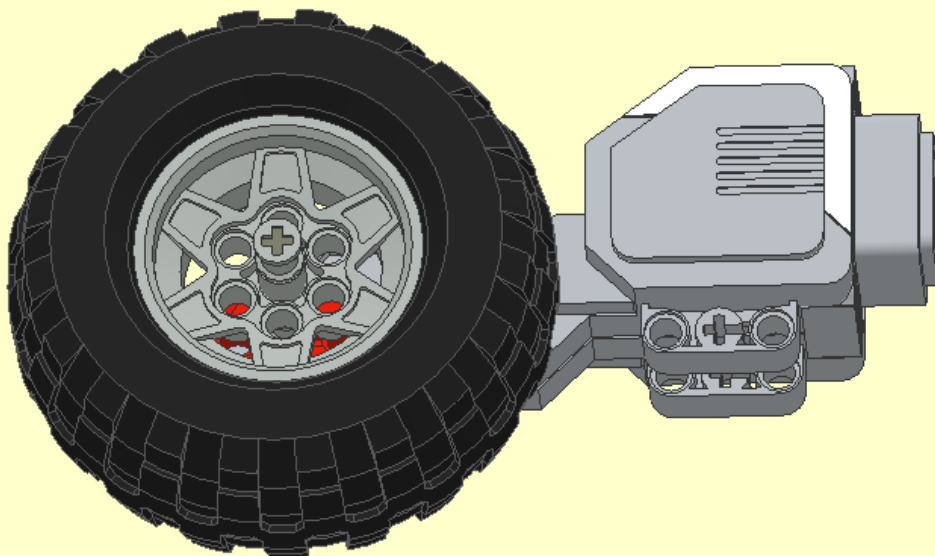

4

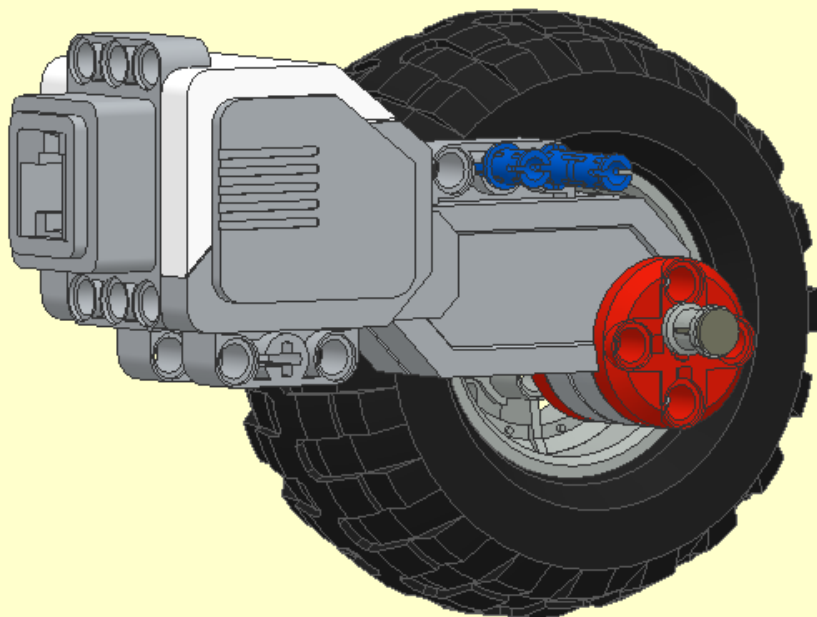
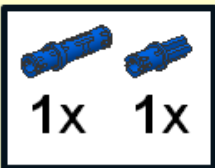

5

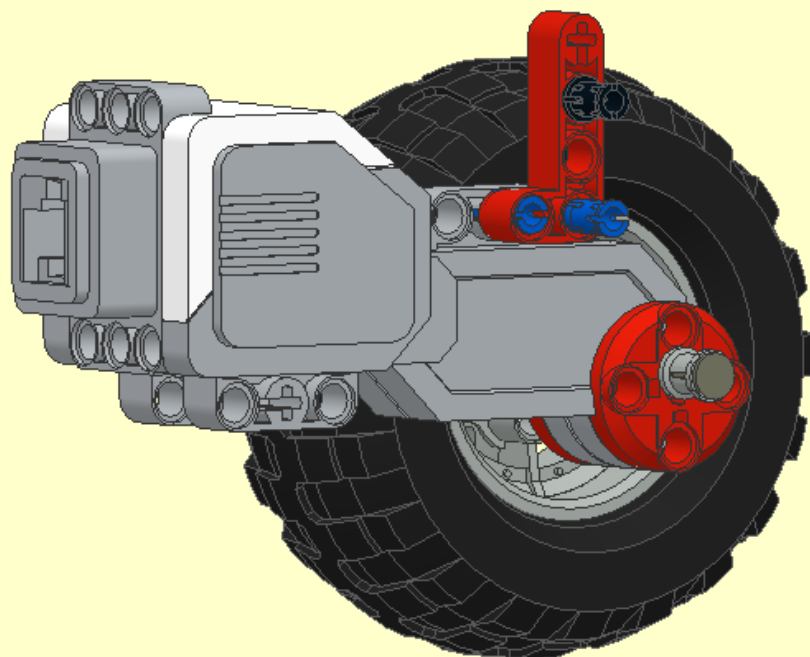
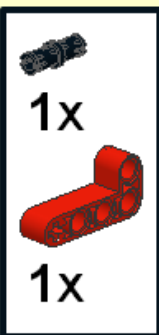

6

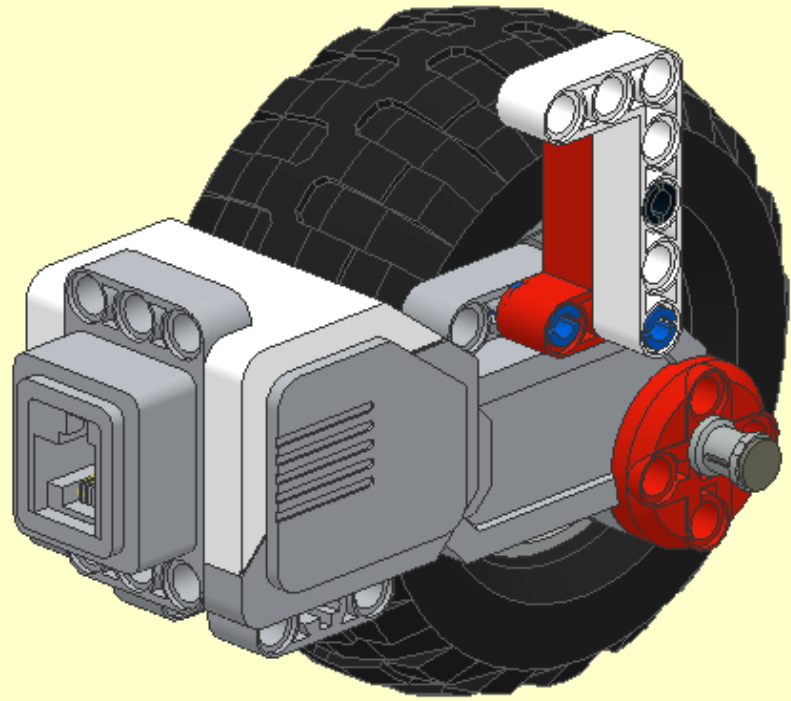
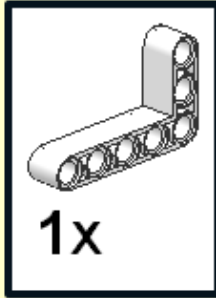

8

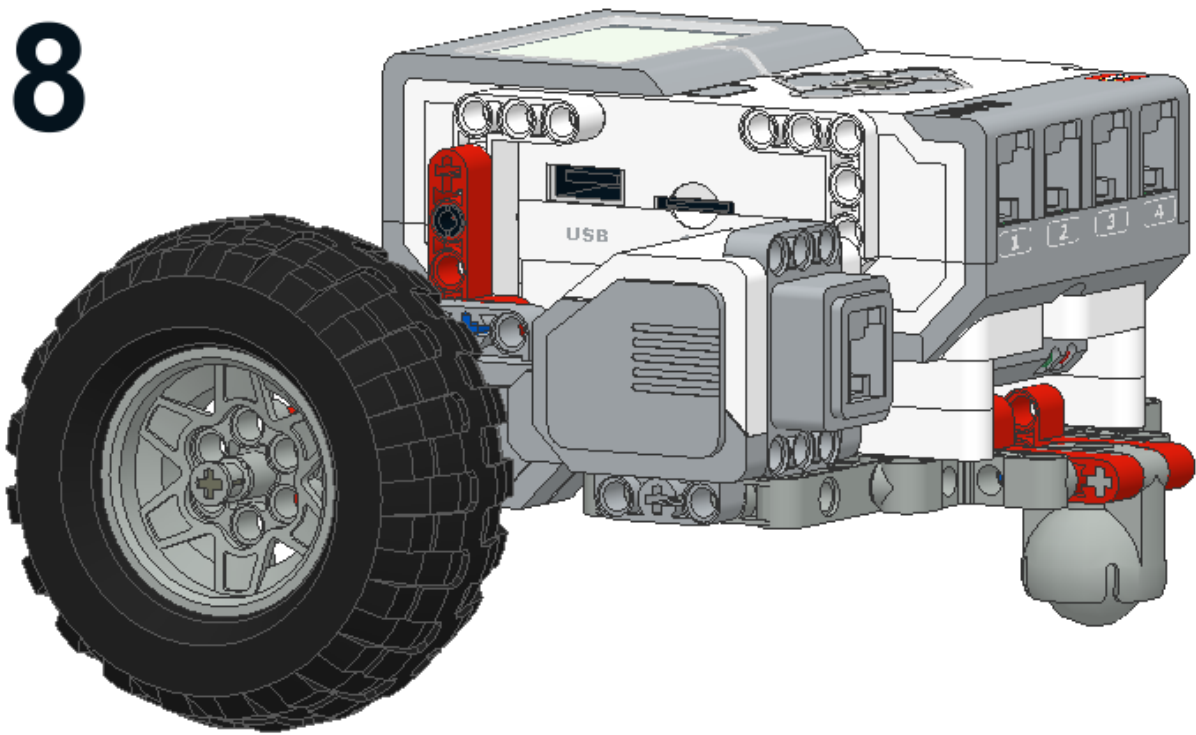

9

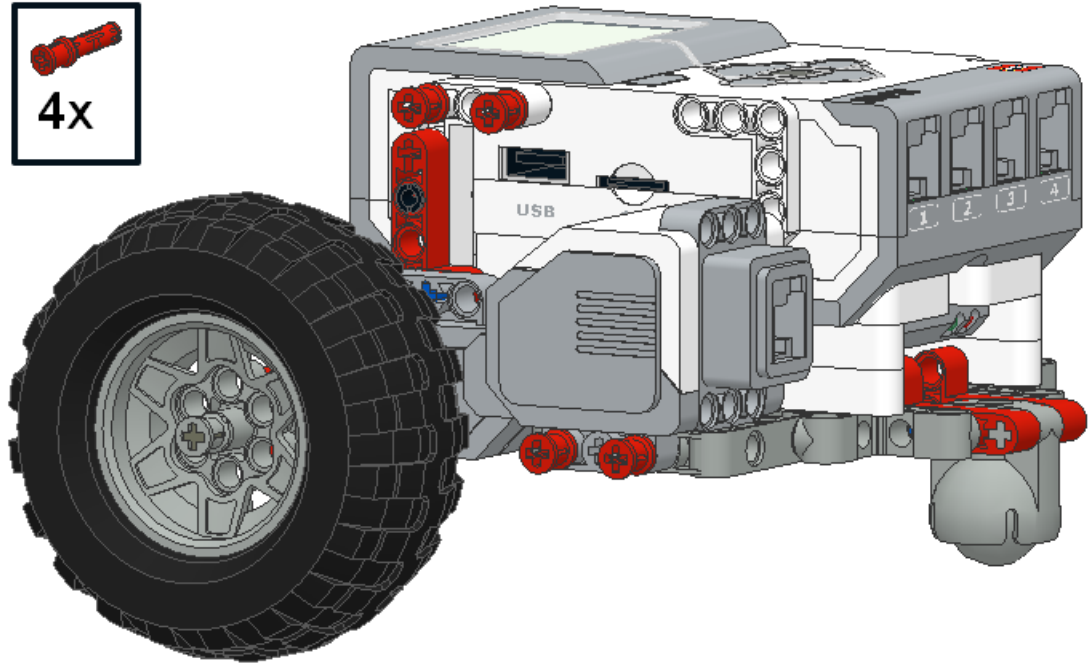

1

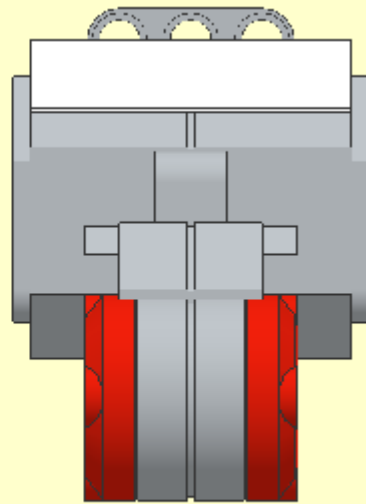
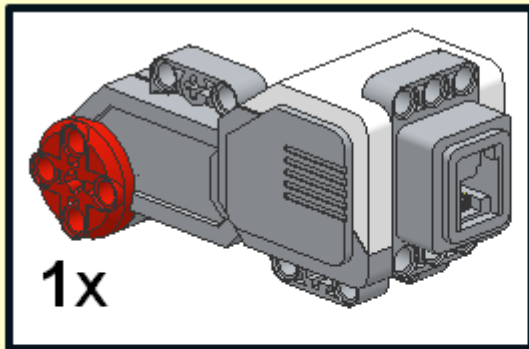

2

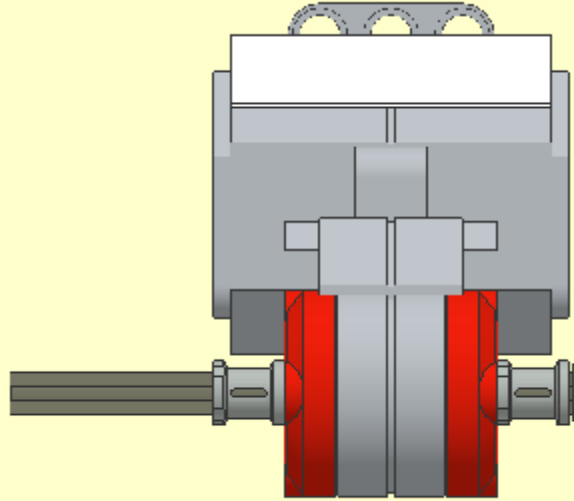
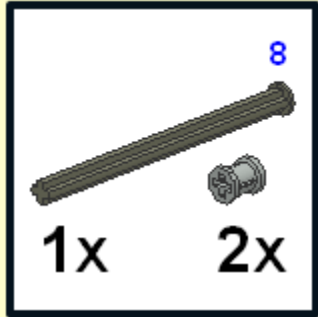

3

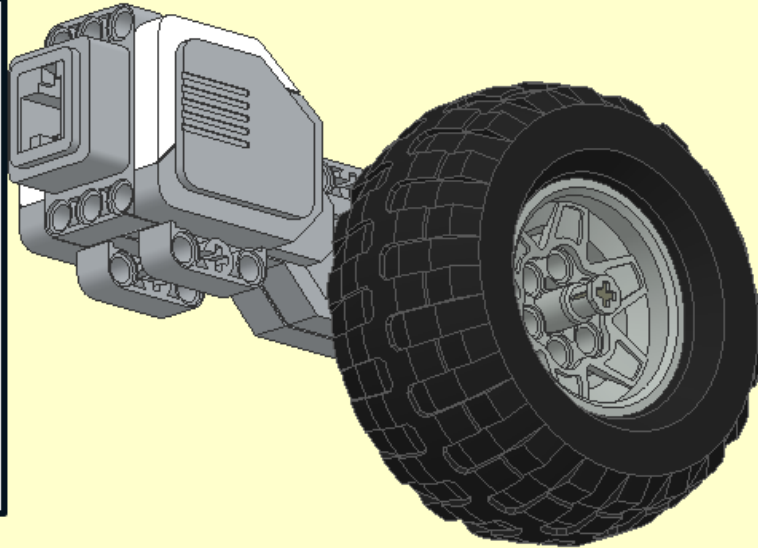
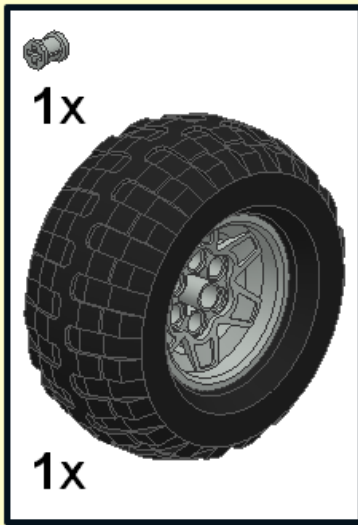

4

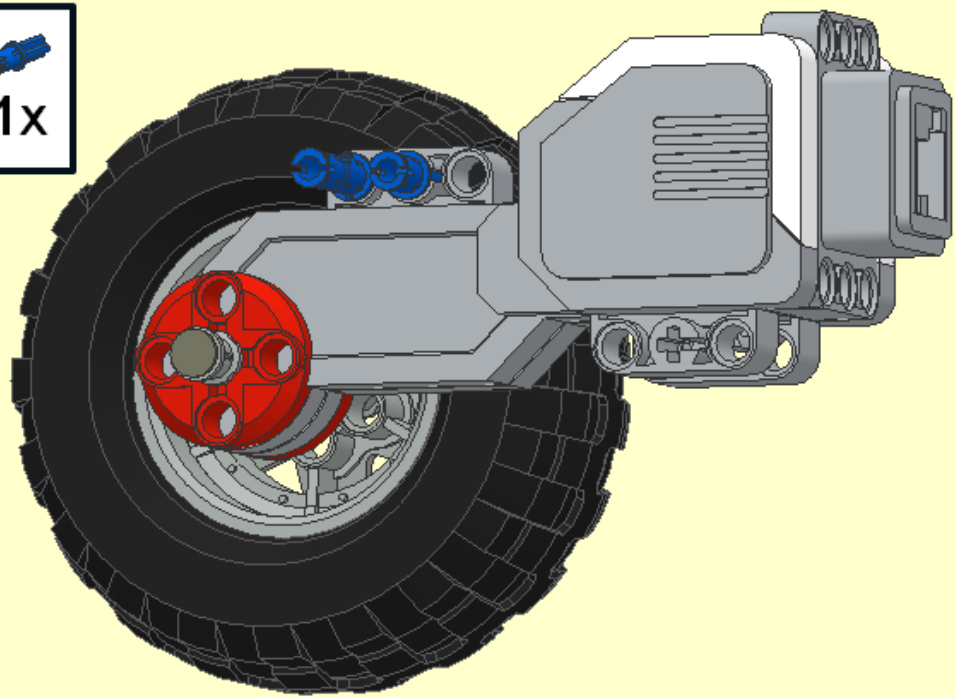
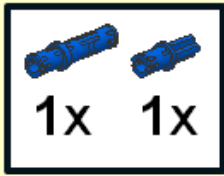

5

- 1x 
- 1x 

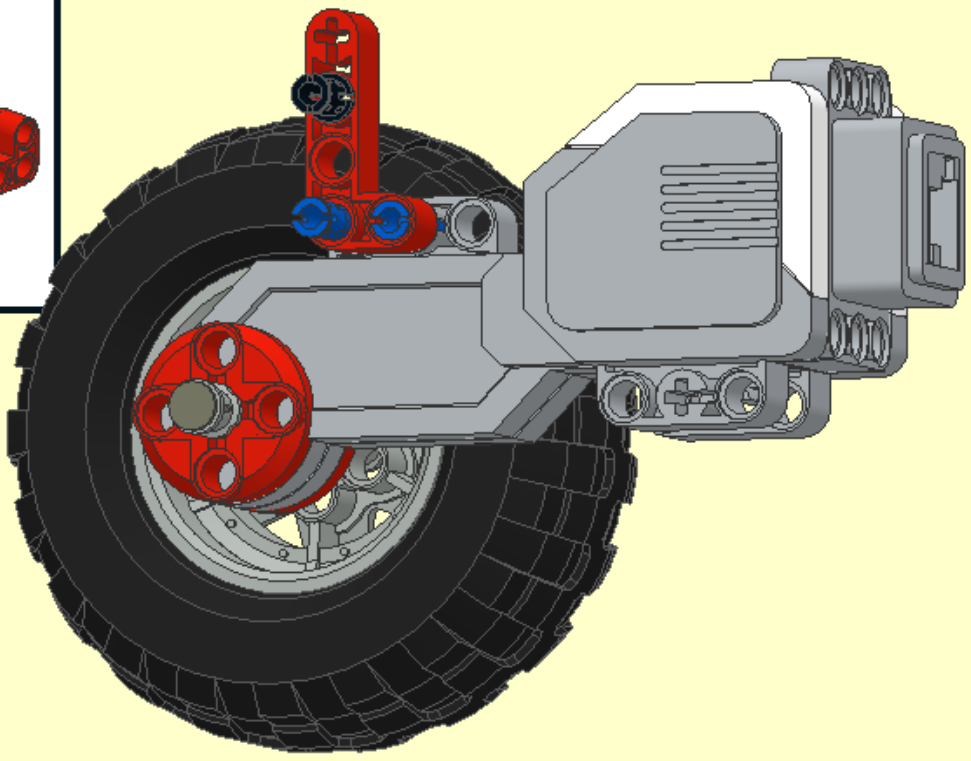

6

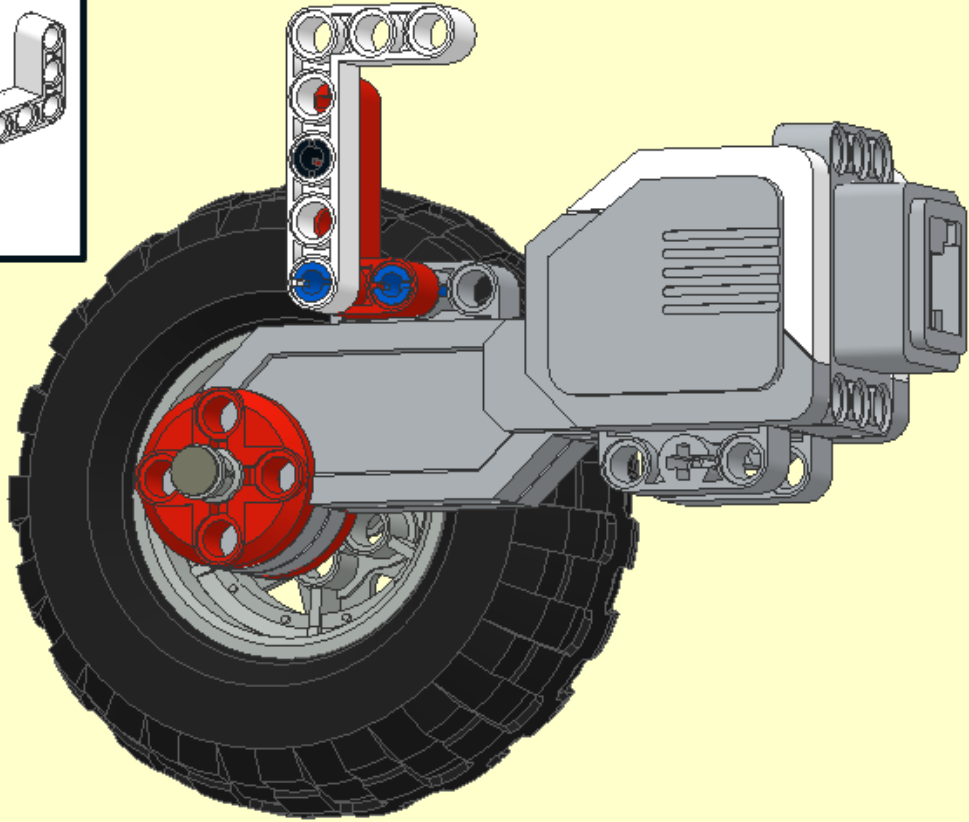
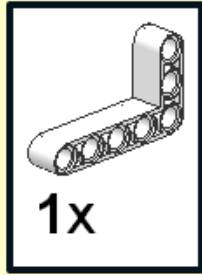

10

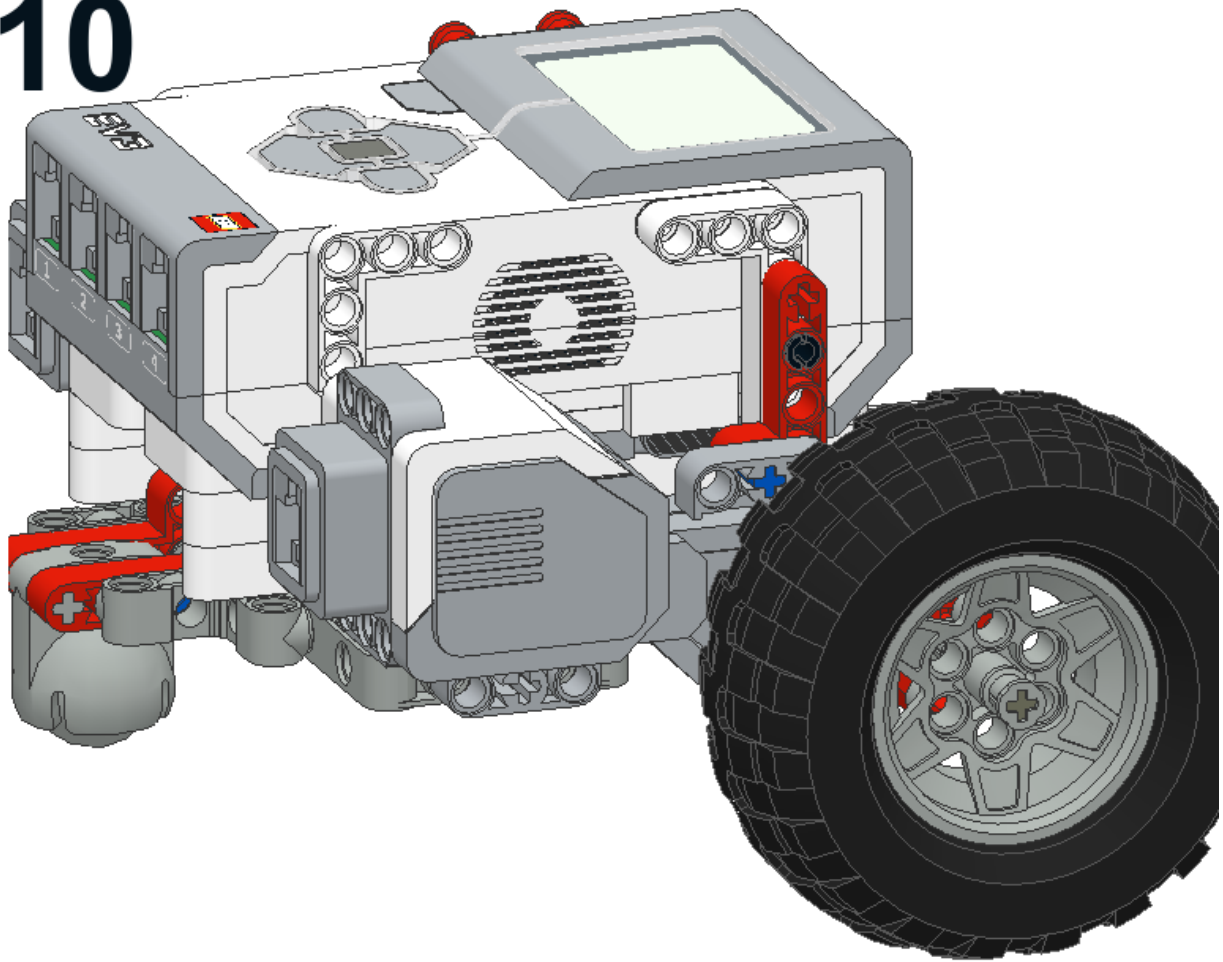

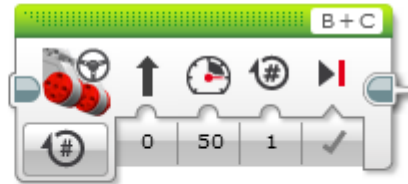
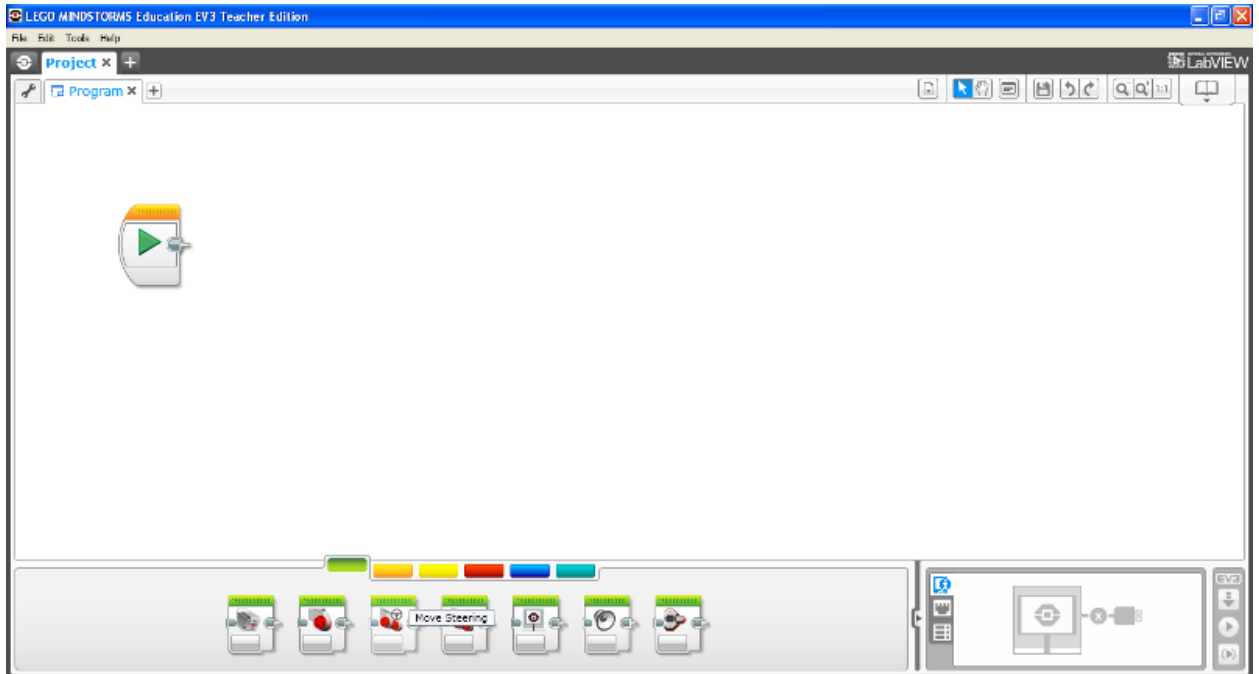

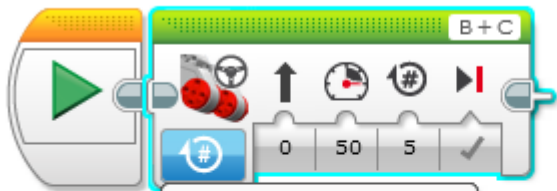

- Off
- On
- On for Seconds
- On for Degrees
- On for Rotations

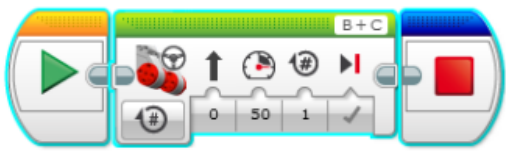

1

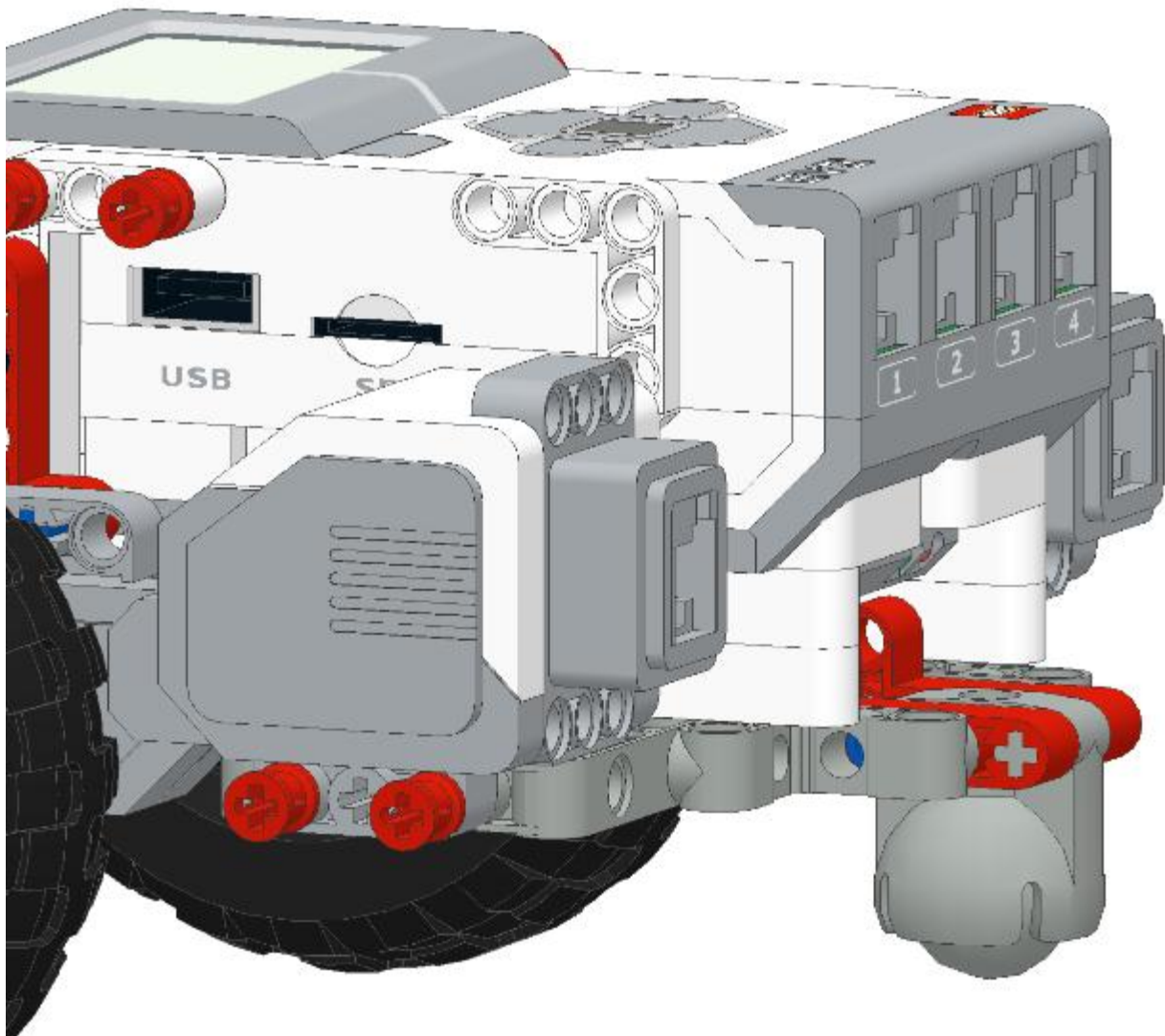

2

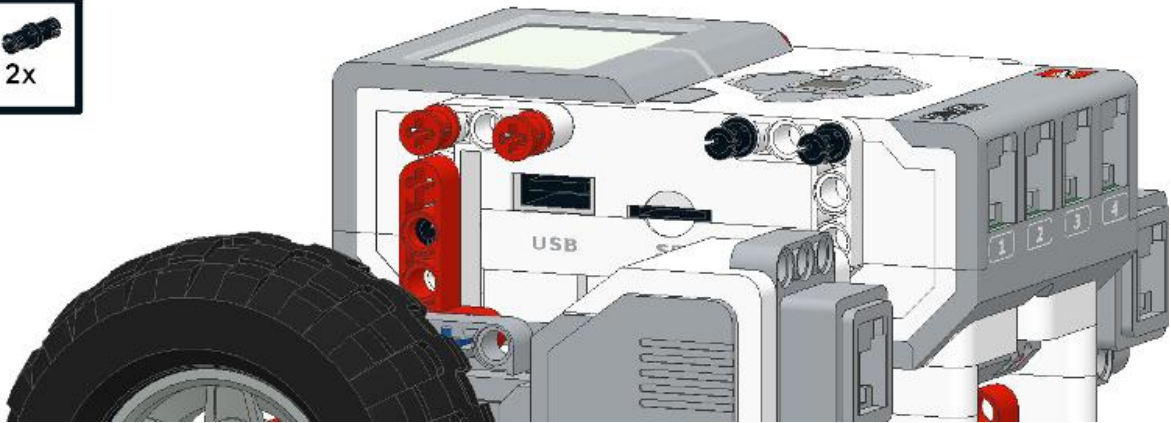

3

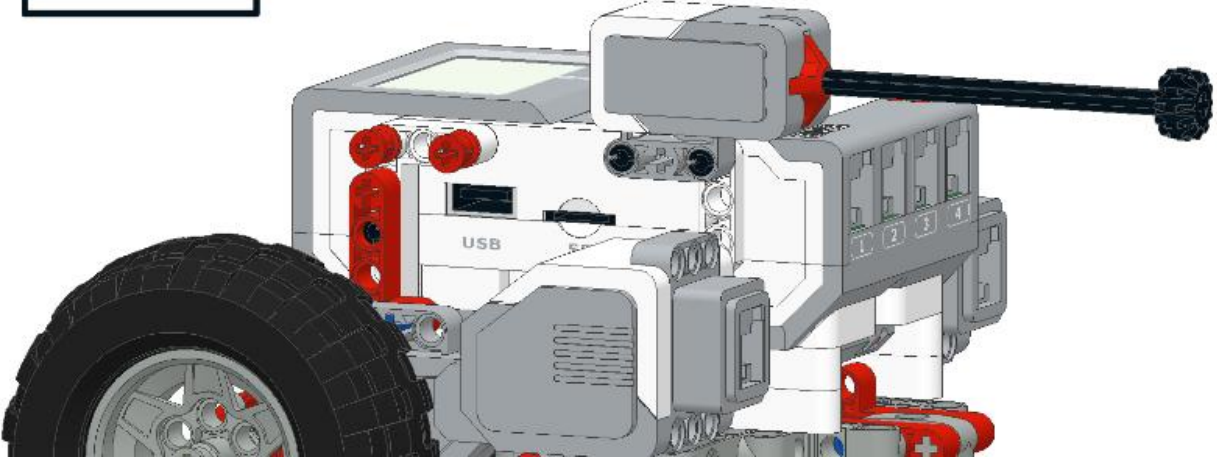
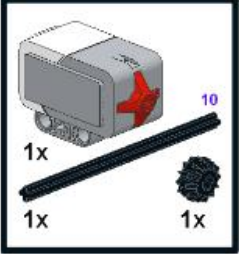

4

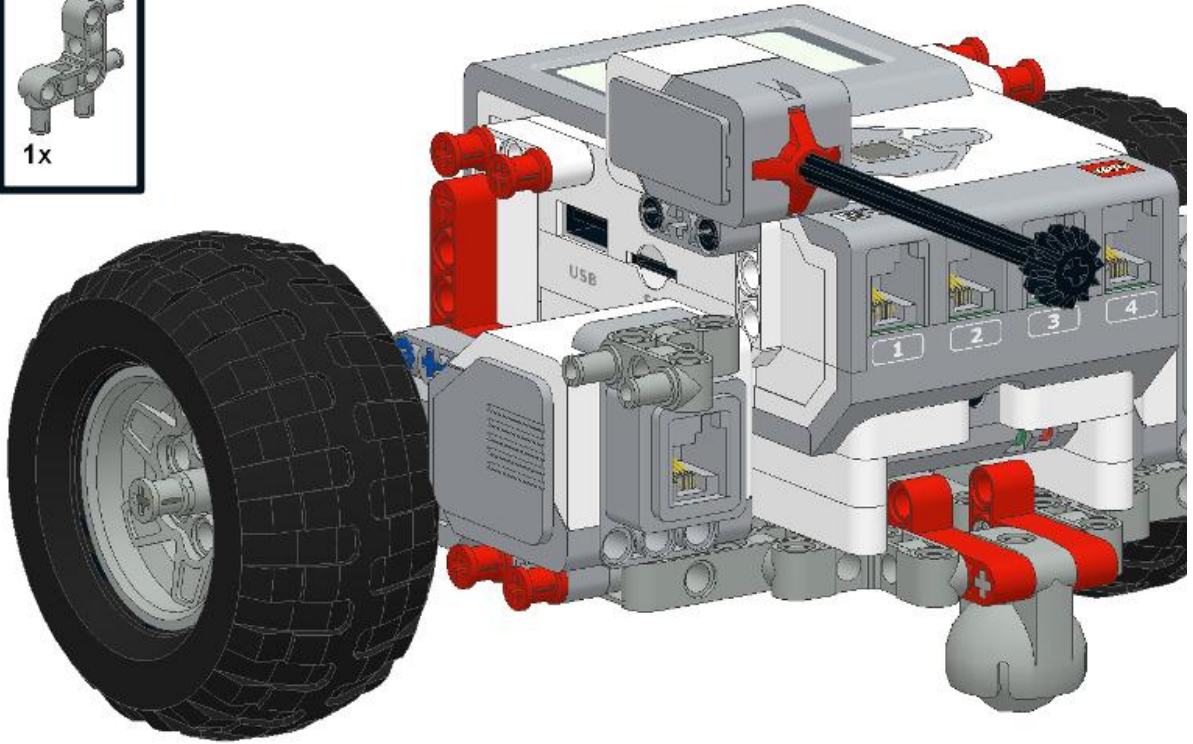
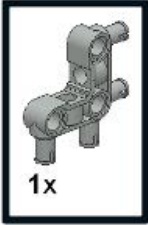

5

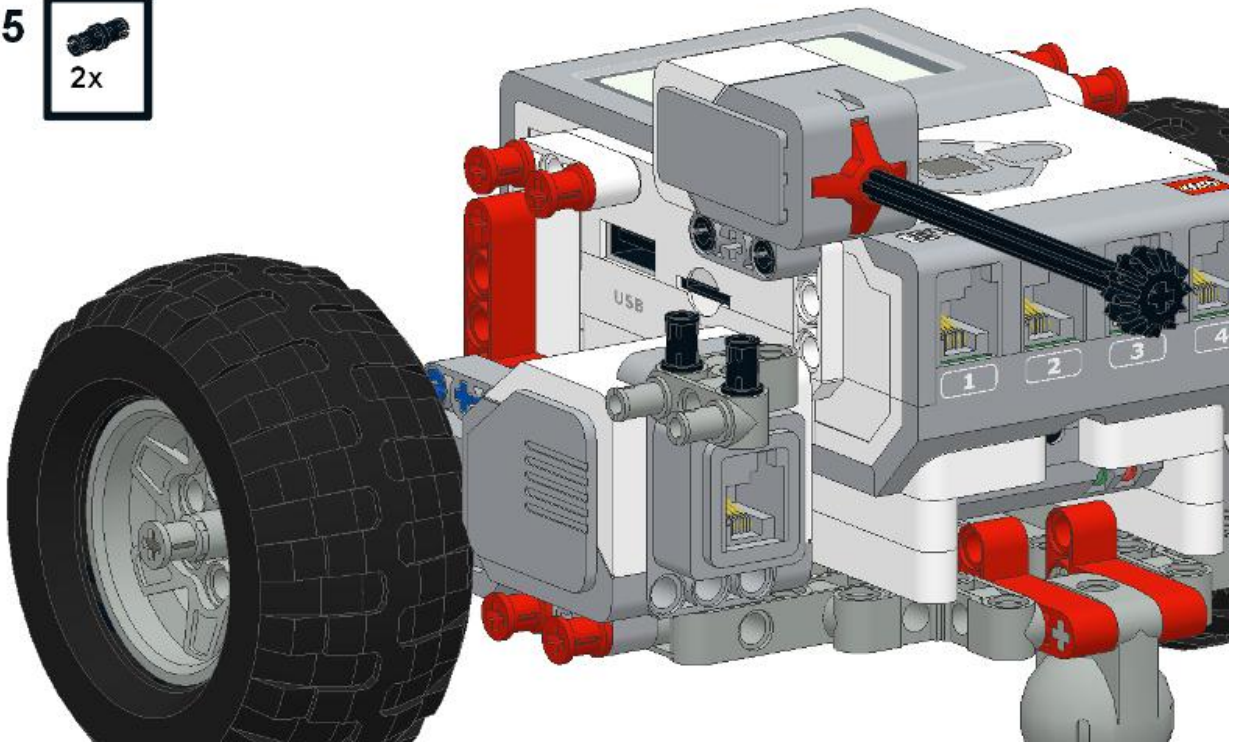

6

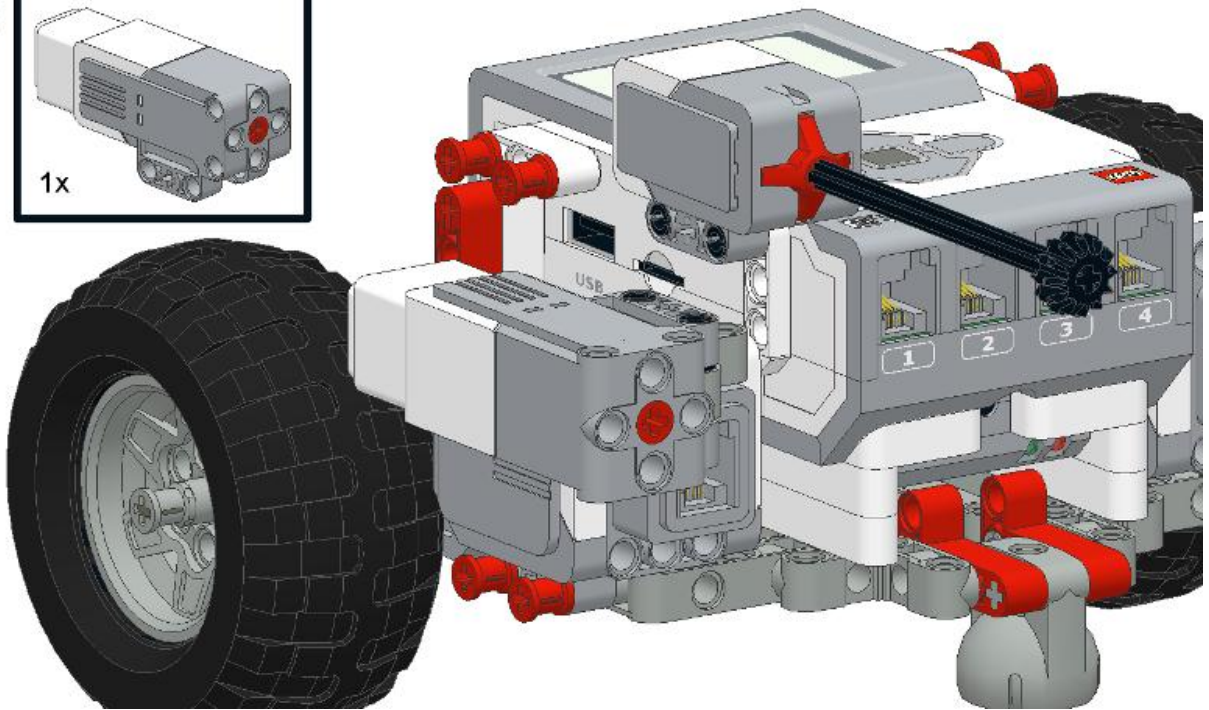
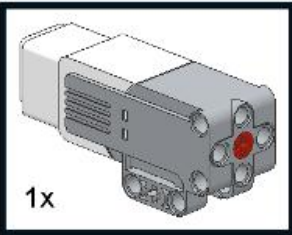

7

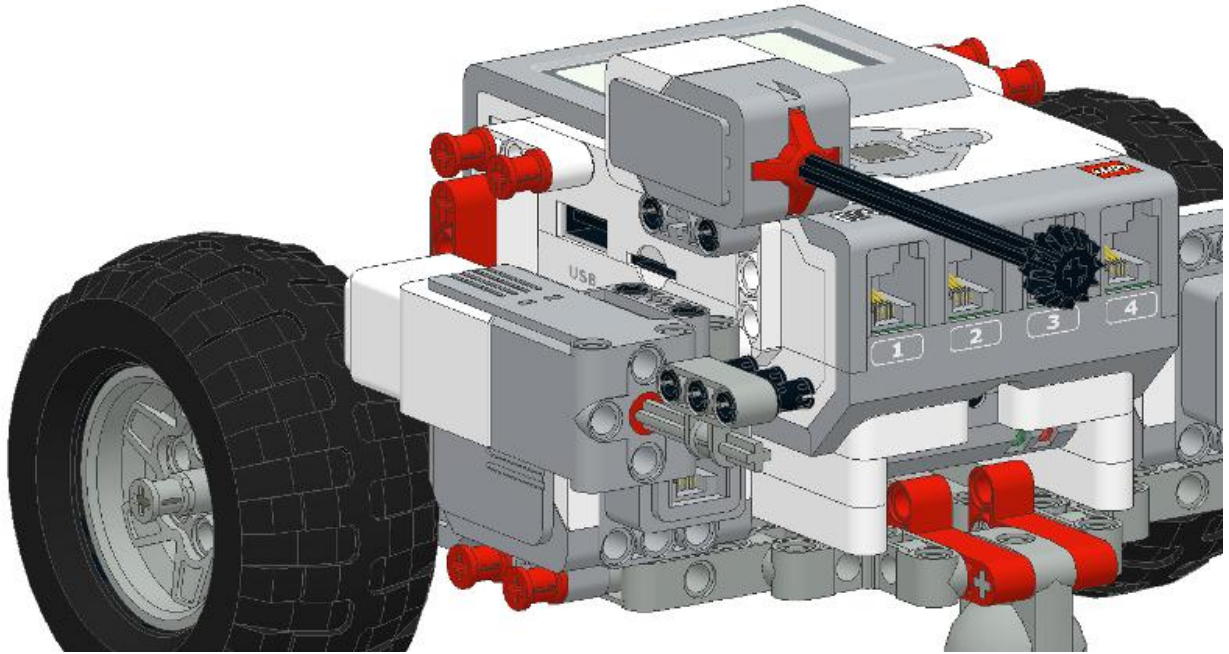
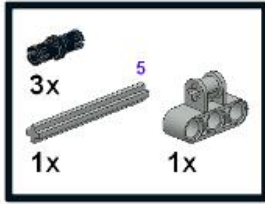

8

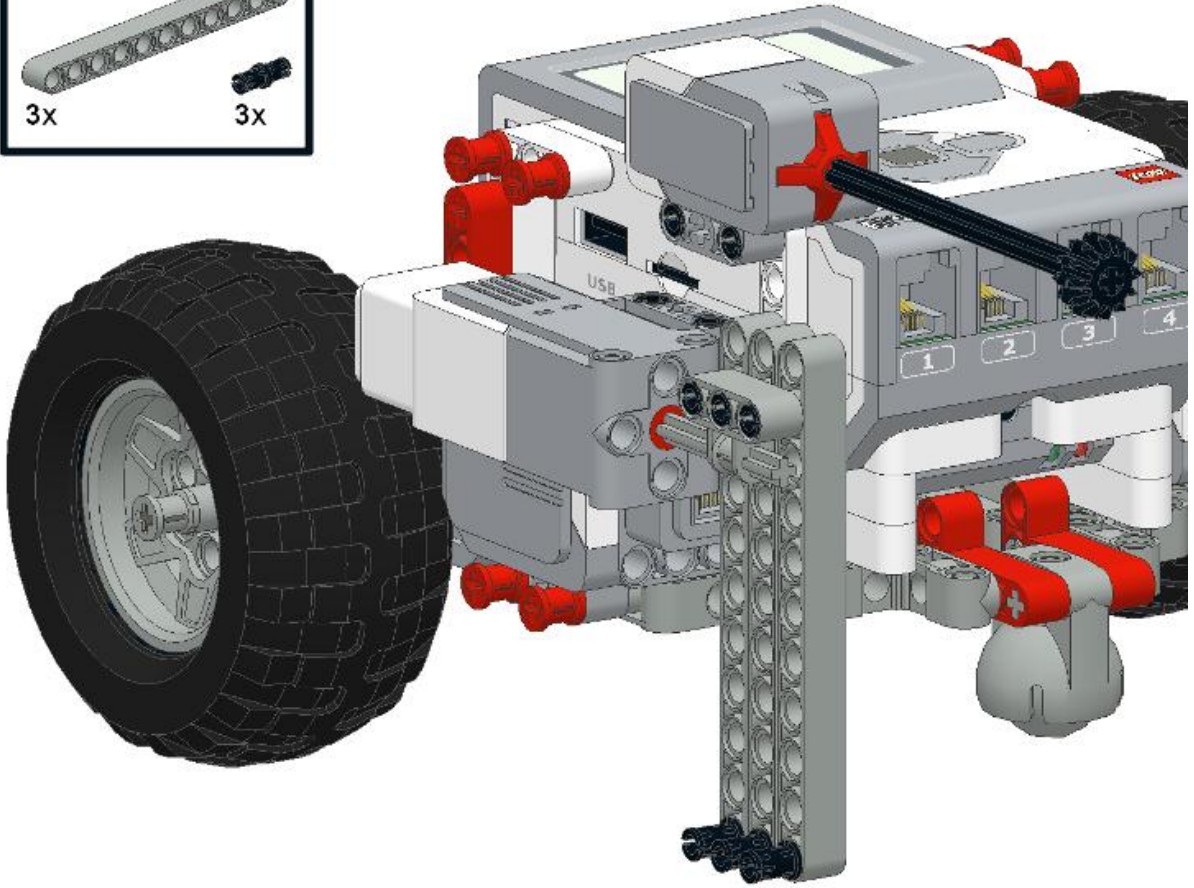
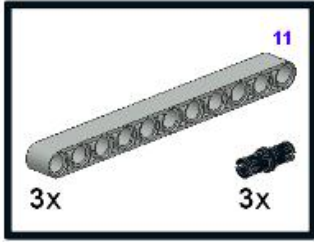

9

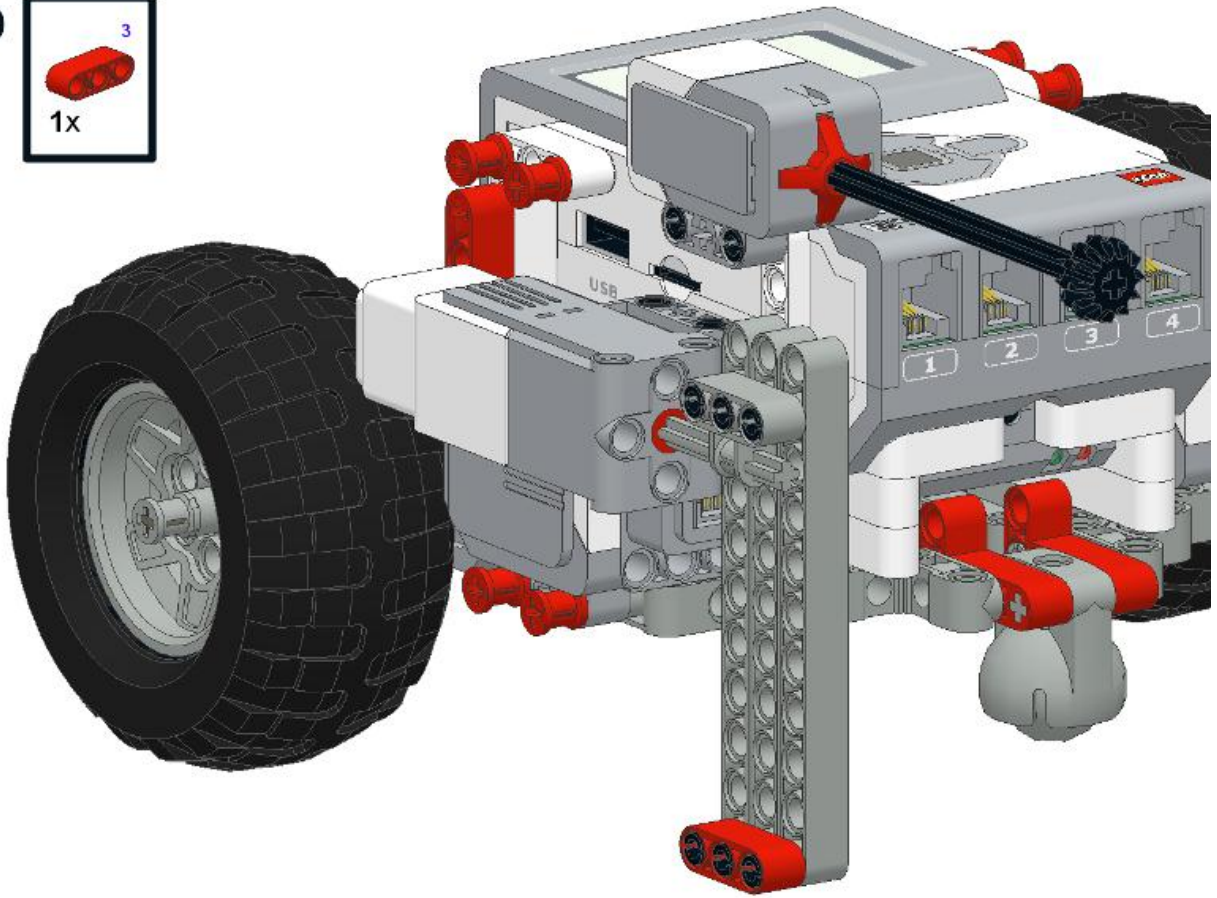
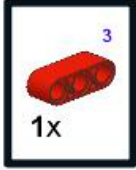

10

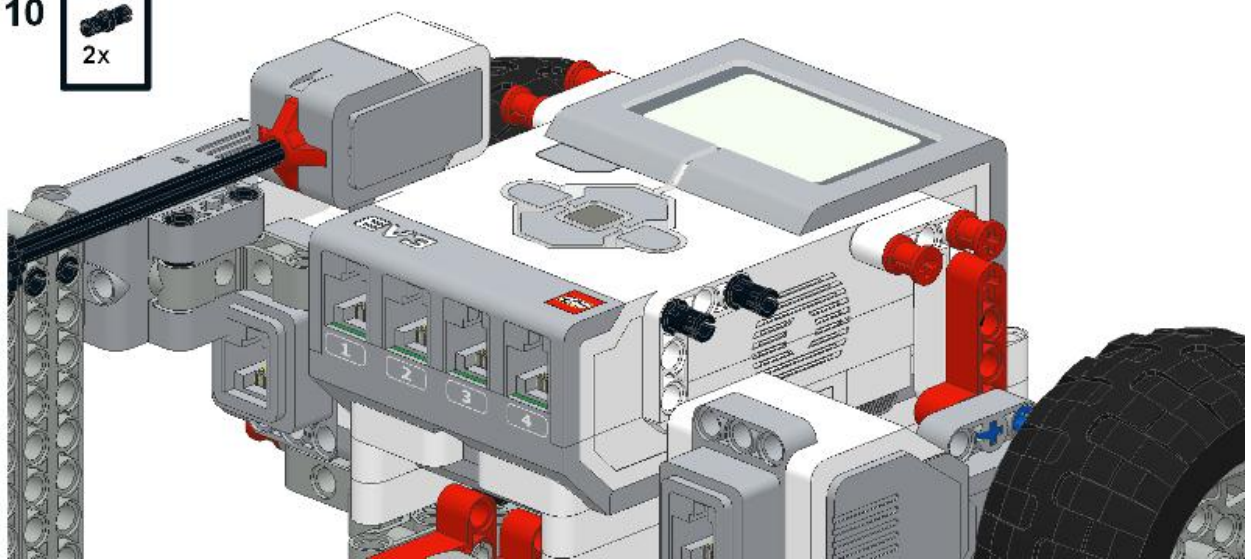

11

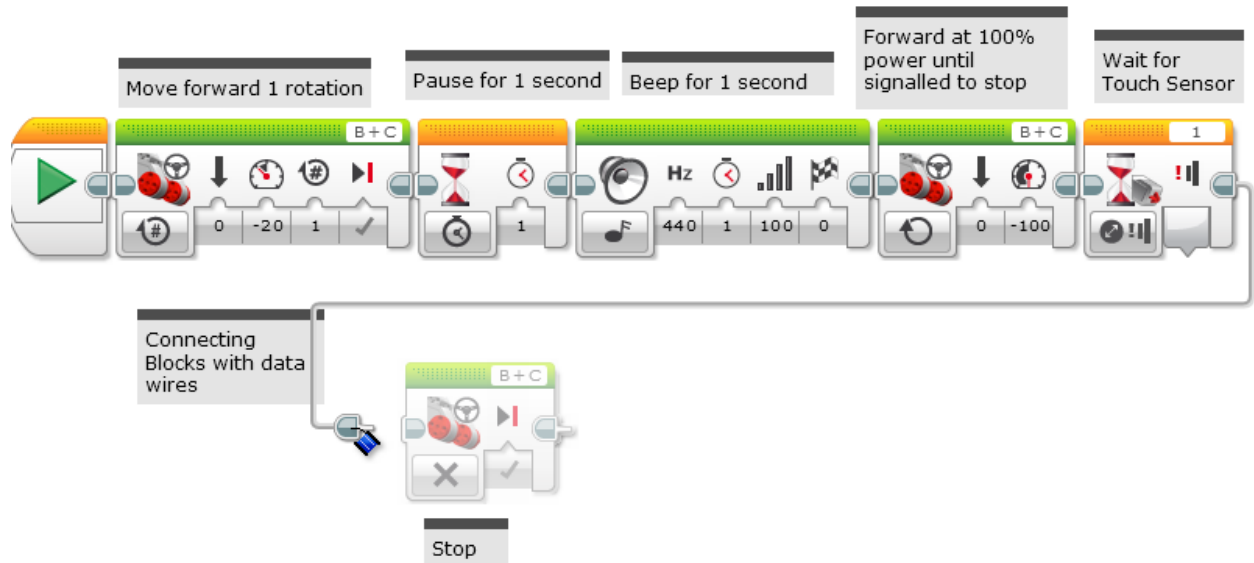
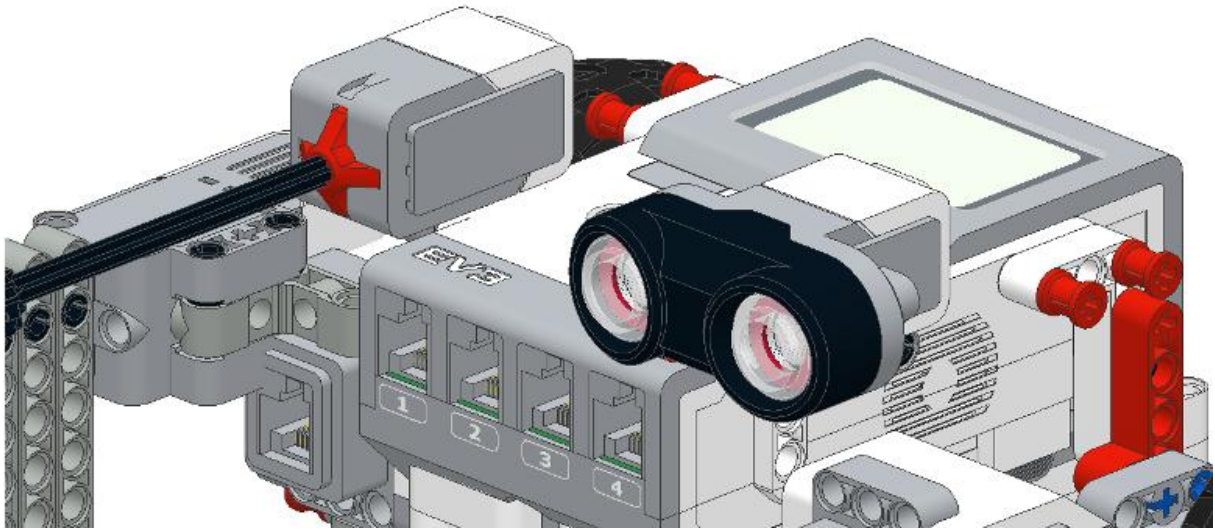
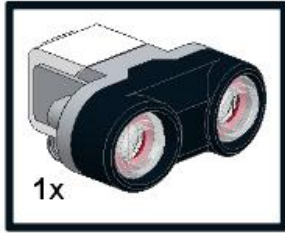

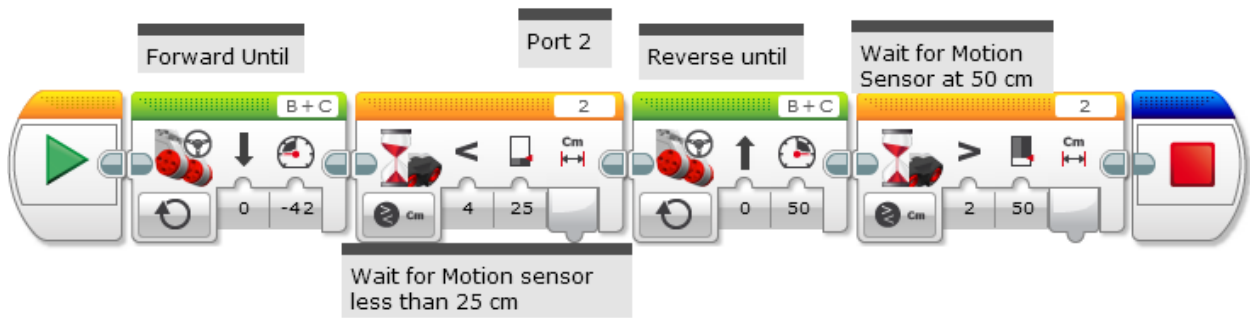
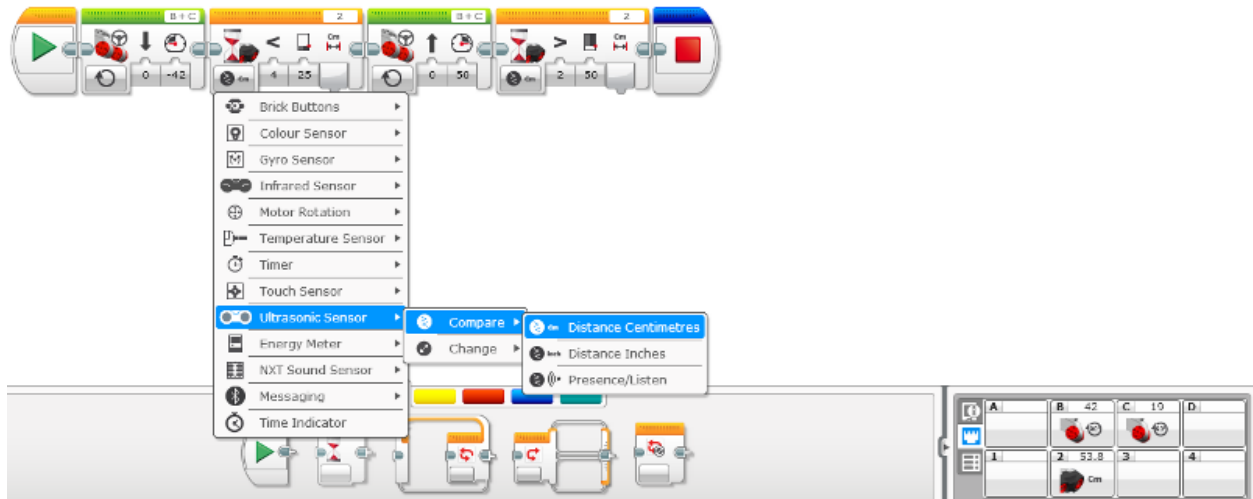
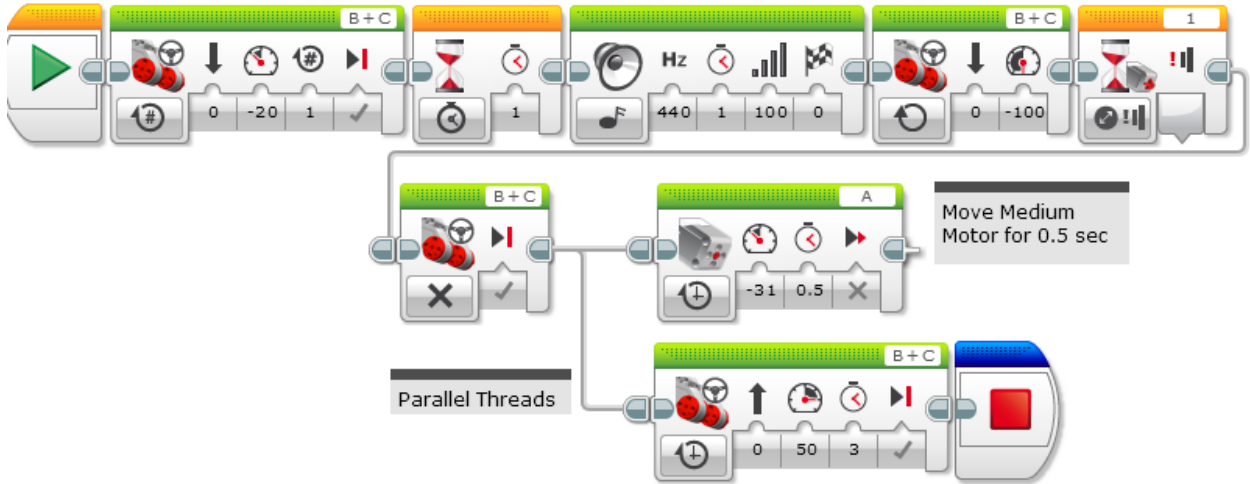

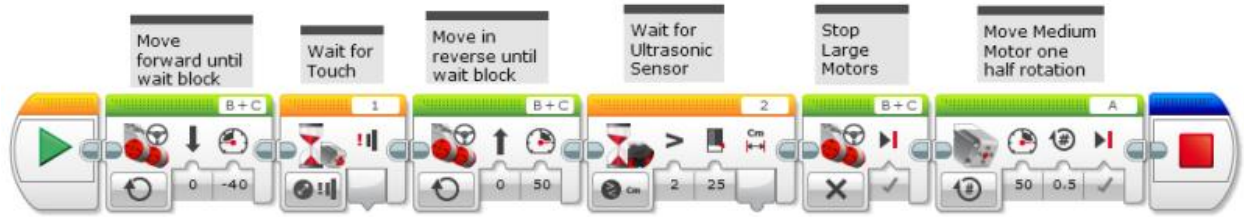

Gyro sensor movement (Medium)

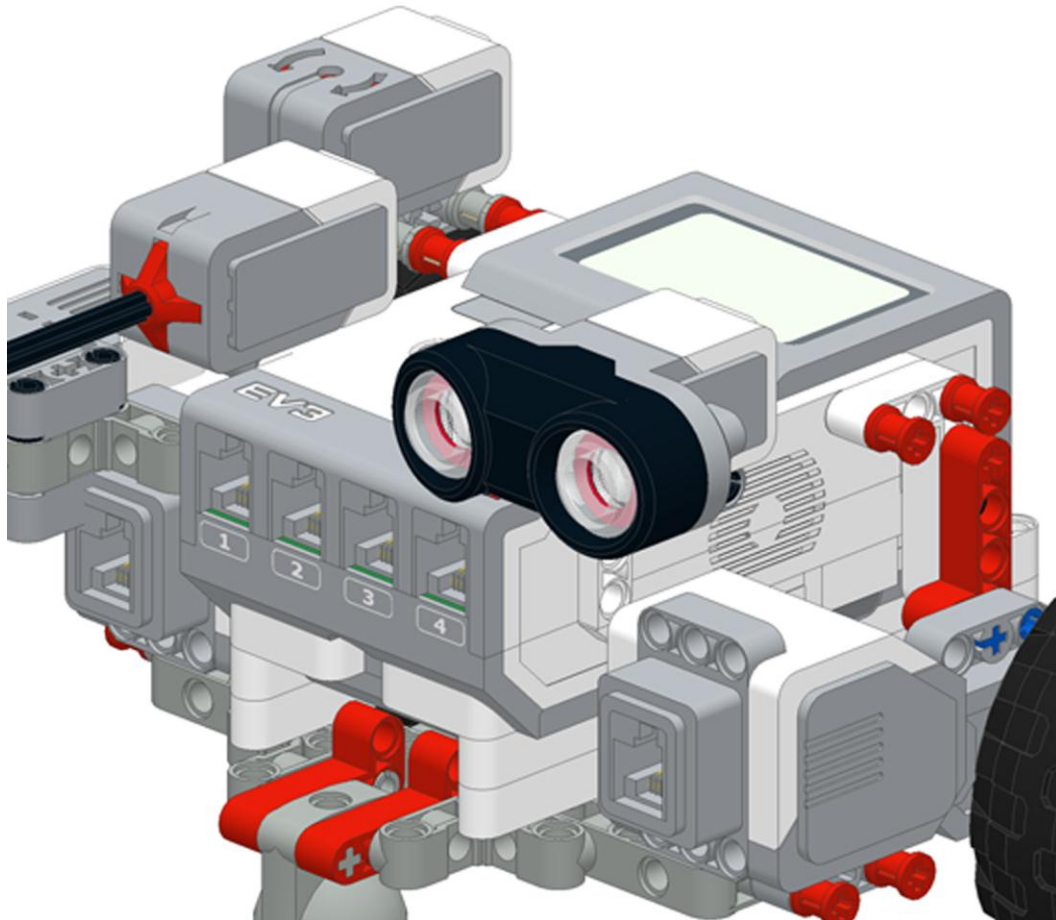
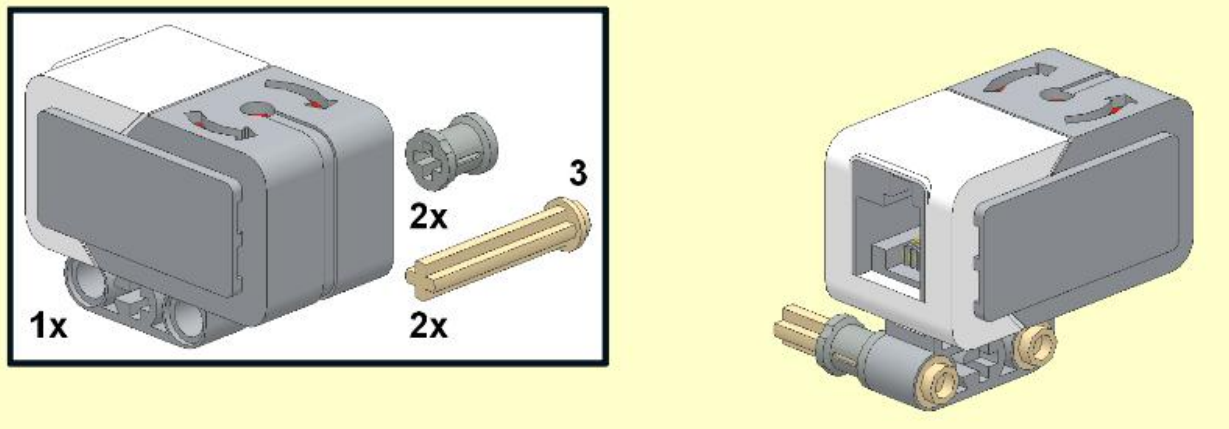

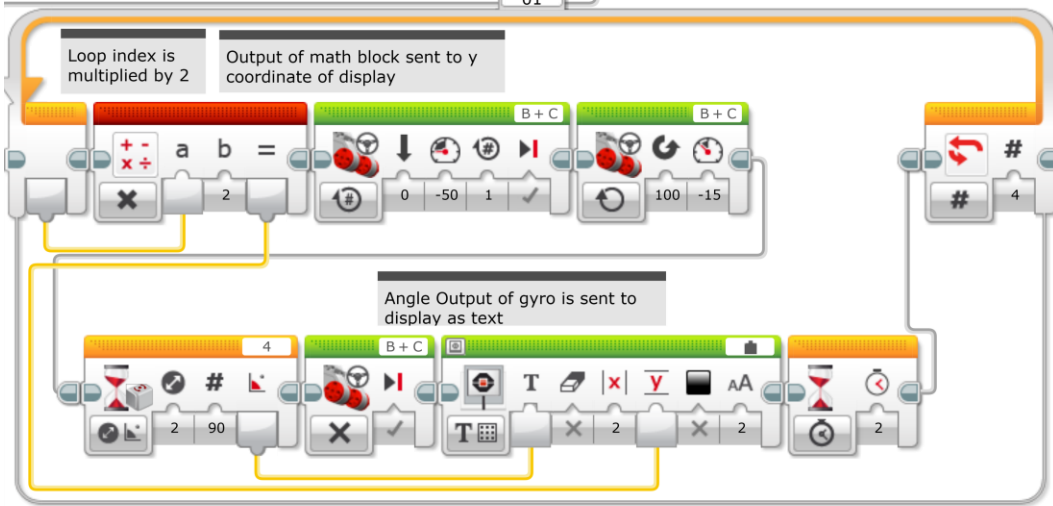
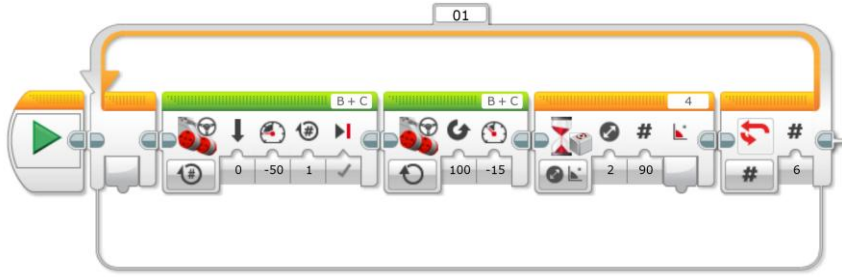

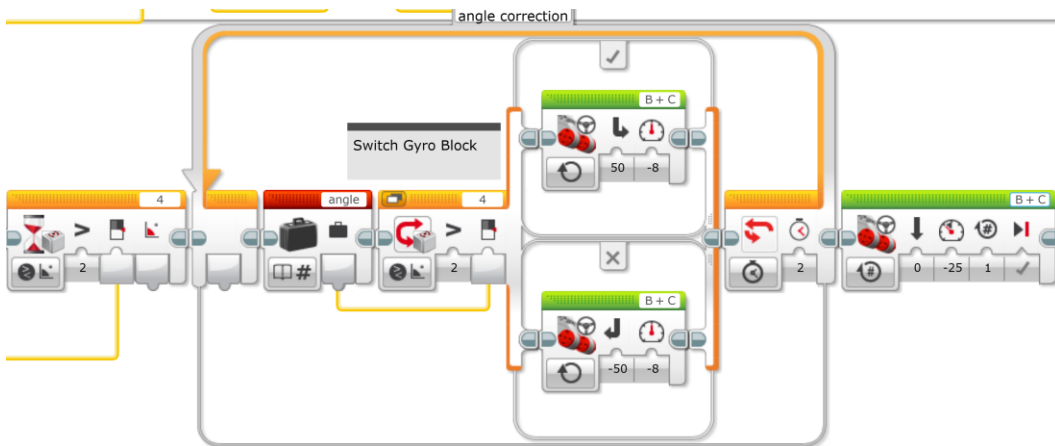
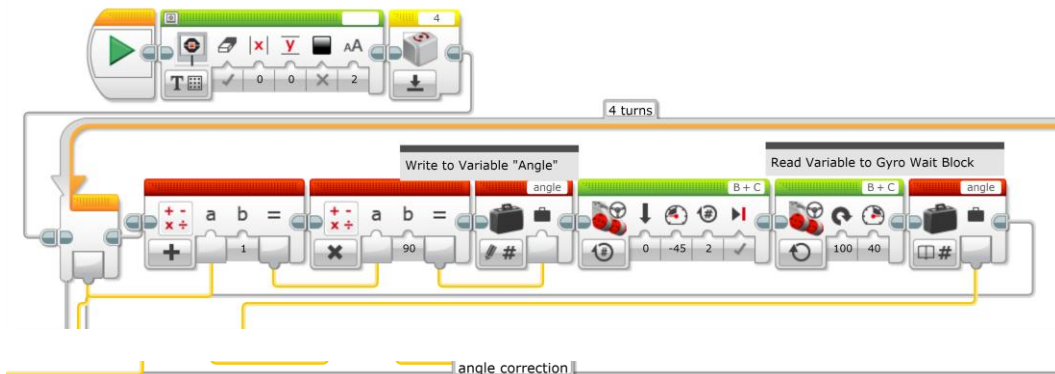
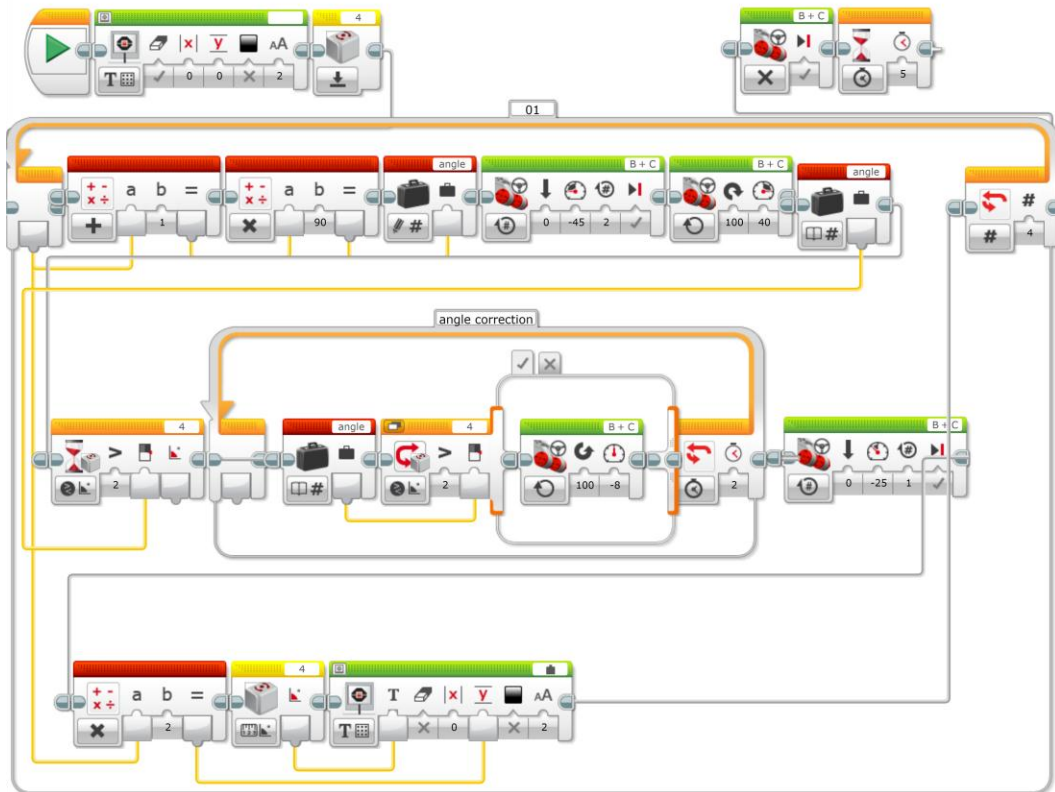

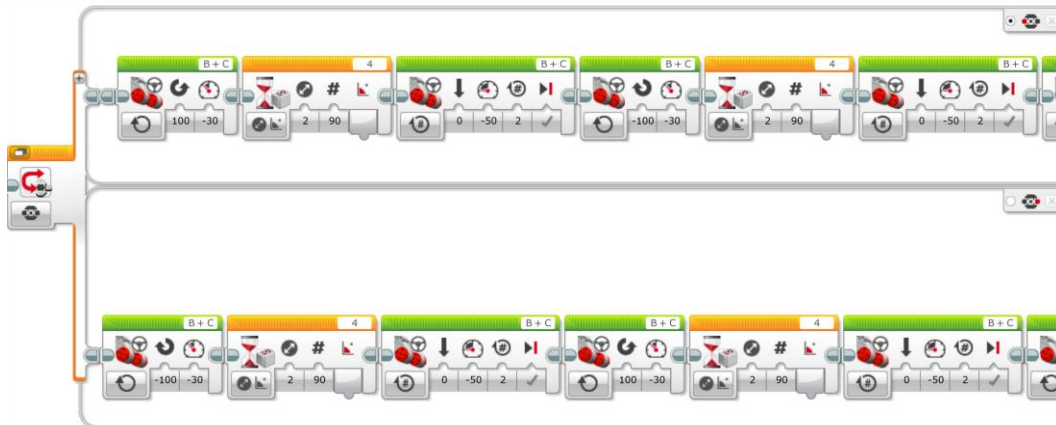
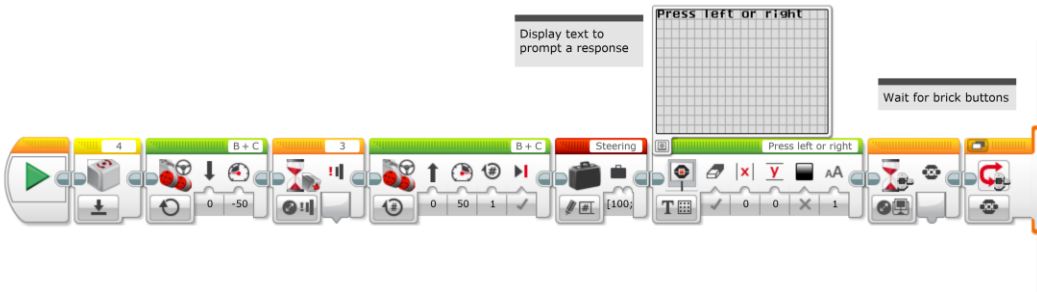
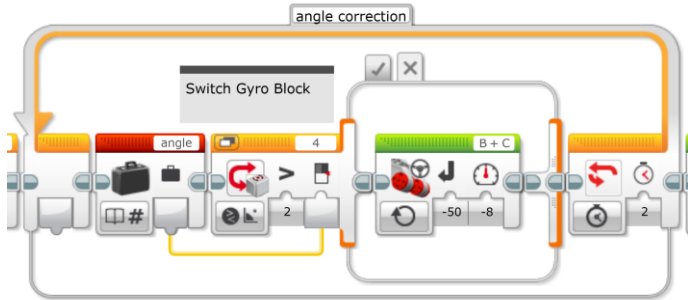
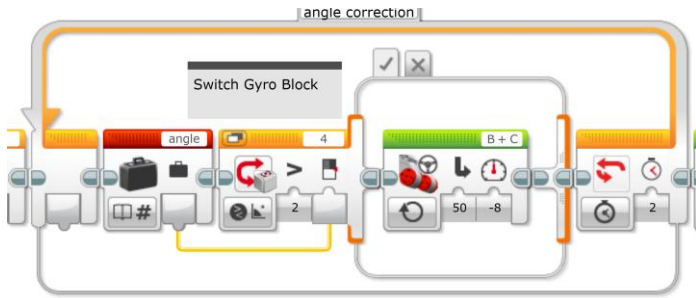

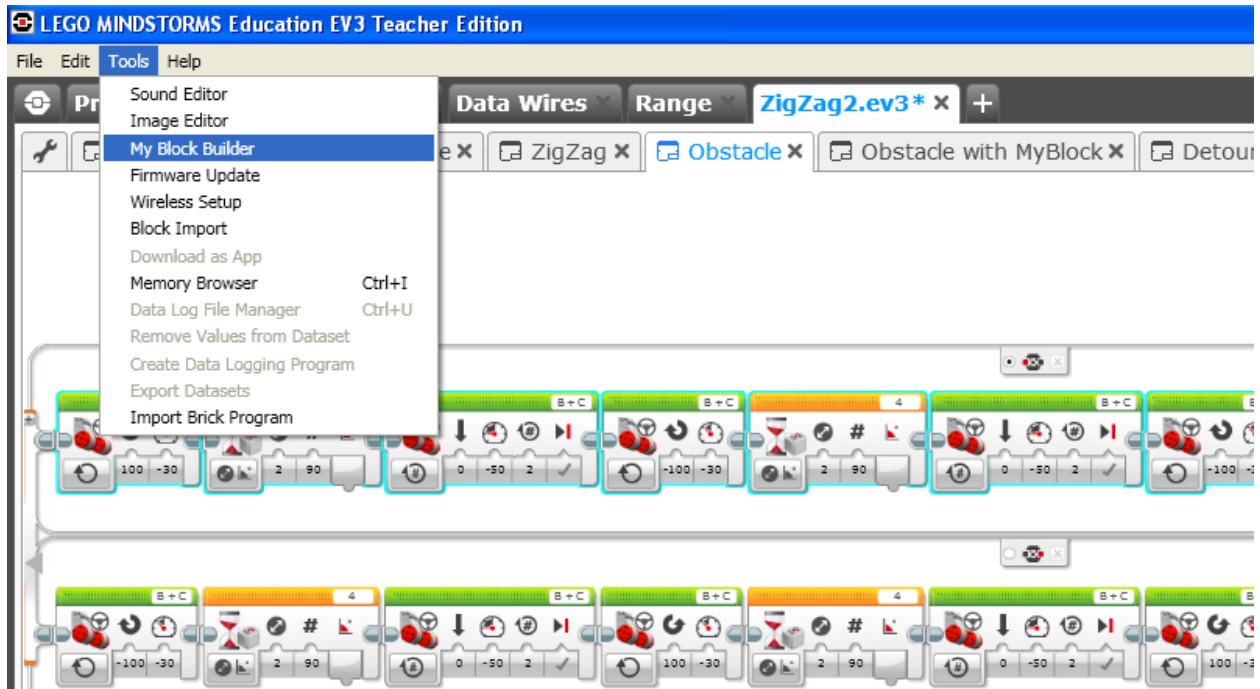
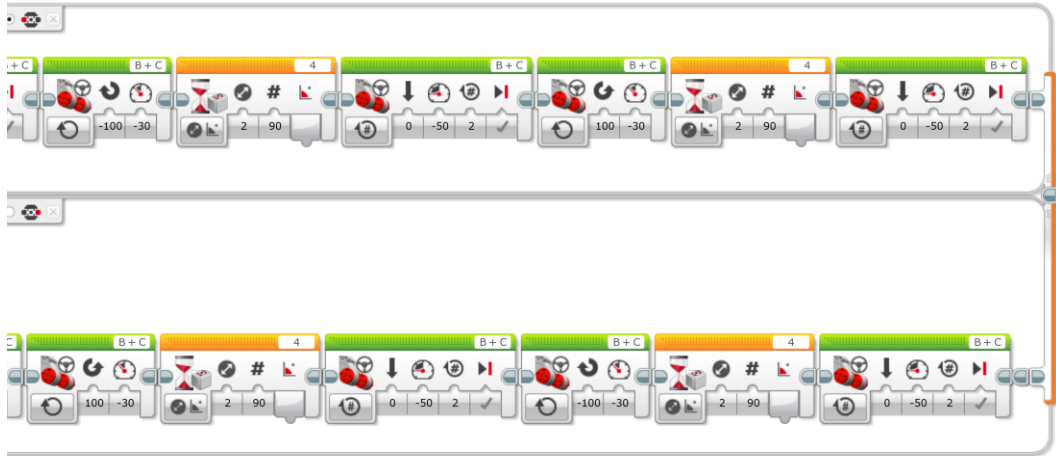



My Block Builder



Click the button to add or edit parameters. 

Name: Description:

My Block Icons

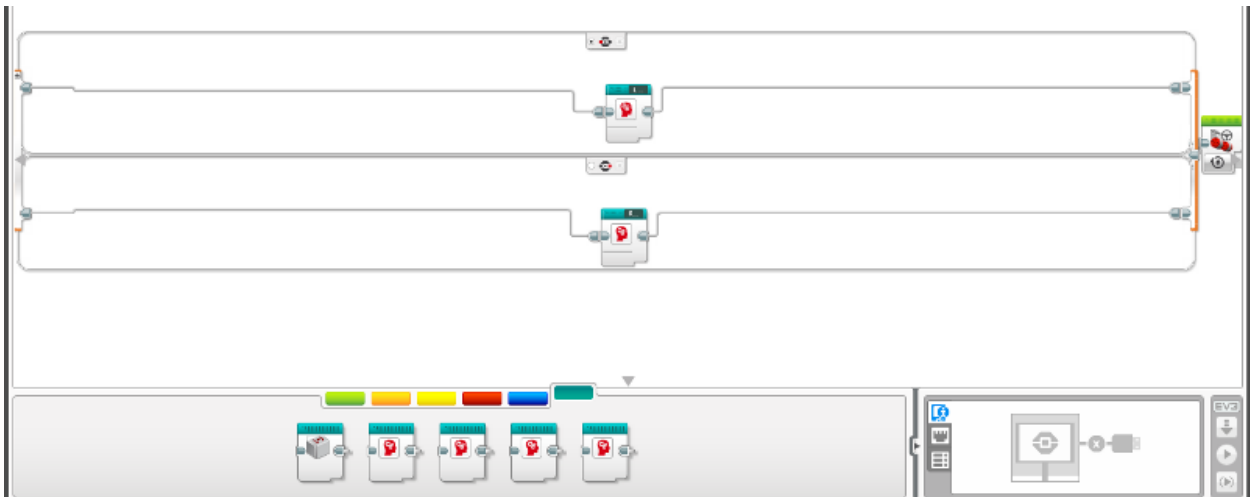

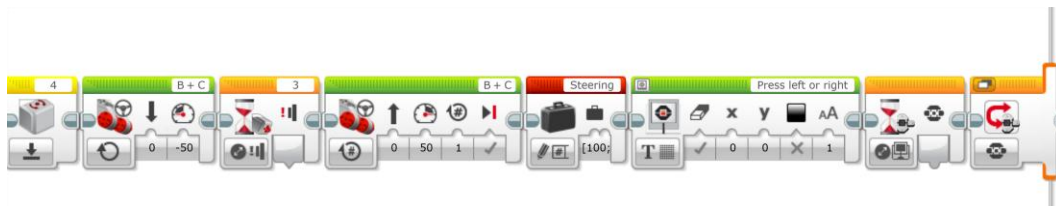
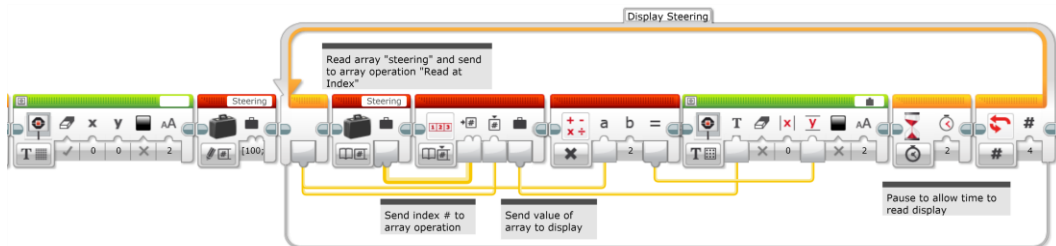
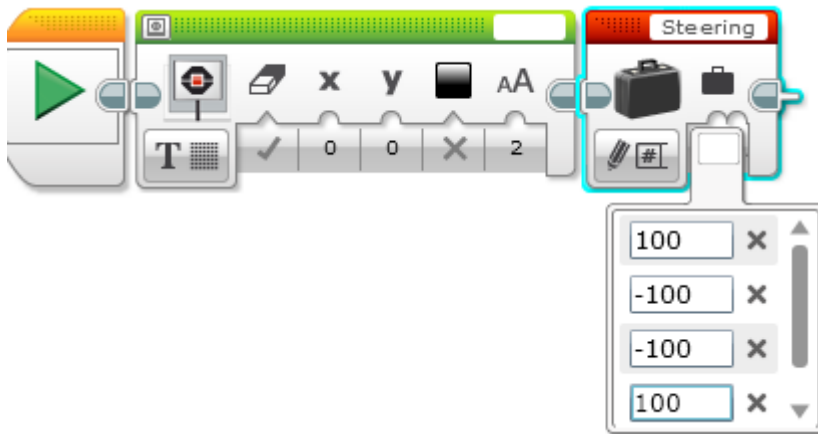
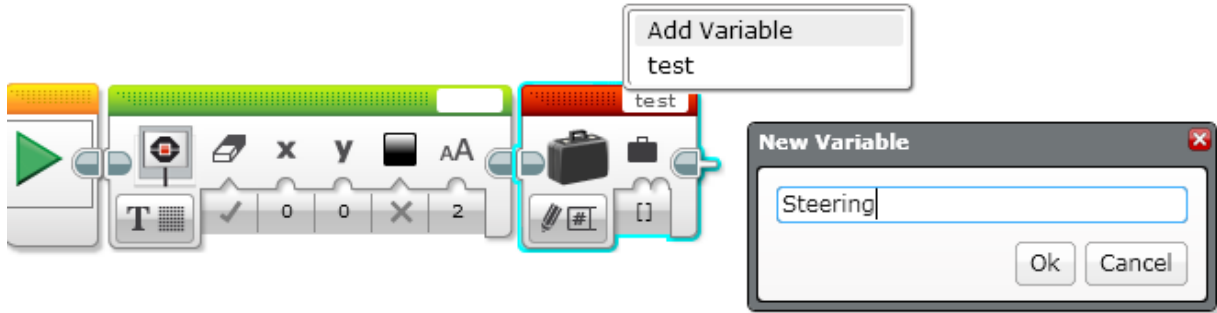

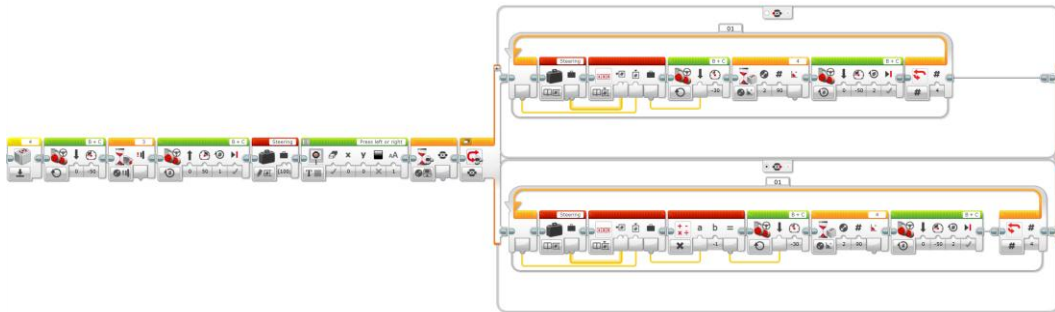
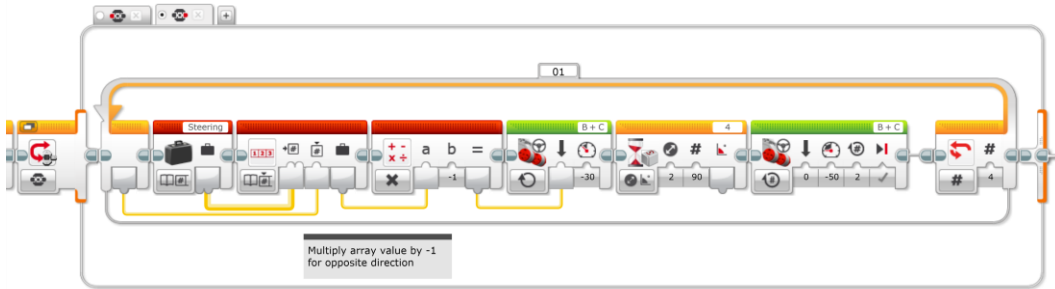
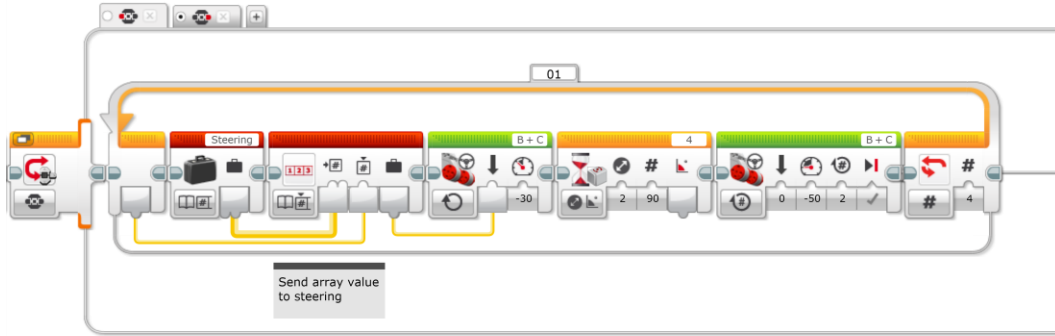

Ultrasonic motion sensing (Advanced)

Just Stop! Using Wait for Motion Sensor Block



Slow Down

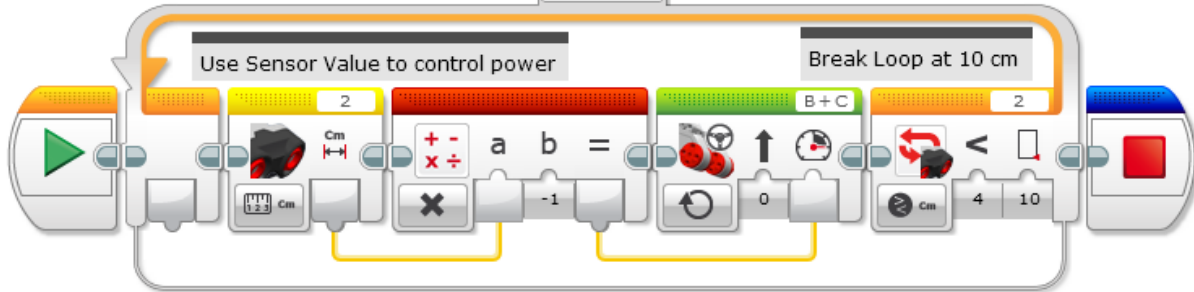

Proportional

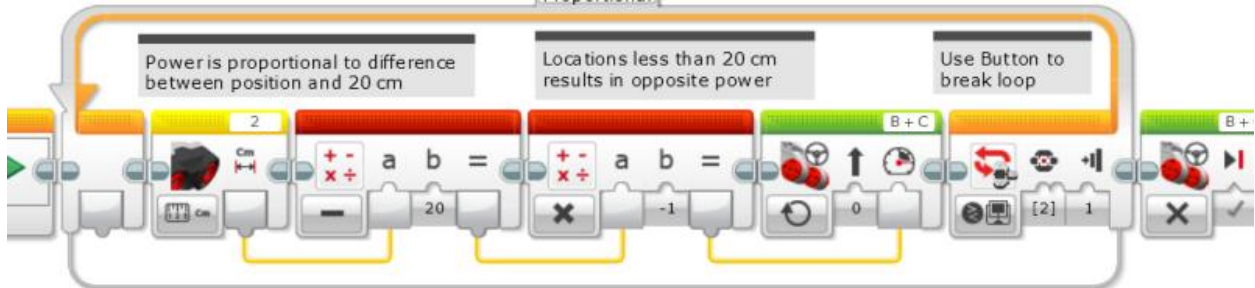

Proportional&Gain

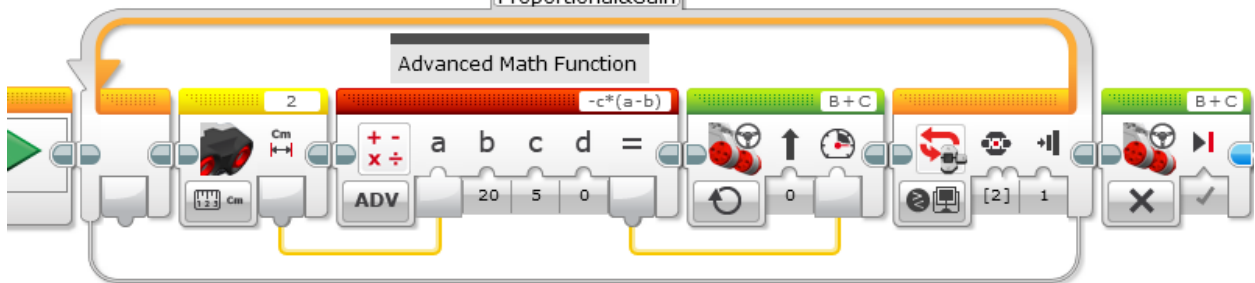

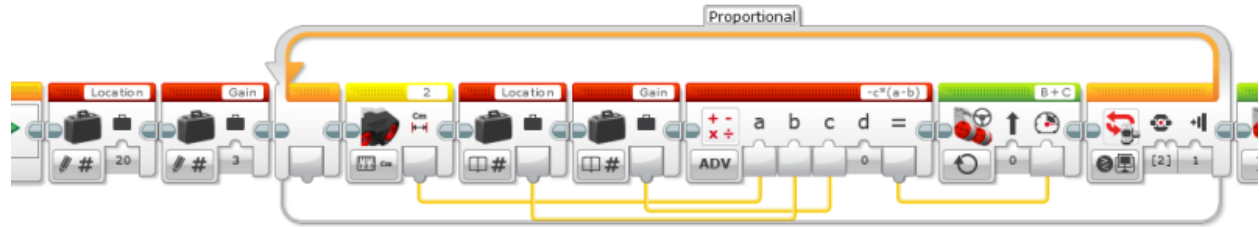

My Block Builder

Name: Proportional

Description:

My Block Icons | Parameter Setup | Parameter Icons

Grid of icons for parameter setup, including mathematical symbols, variables, and control elements.

My Block Builder

Name: Proportional

Description: This will allow an input for the location variable

My Block Icons | **Parameter Setup** | Parameter Icons

Name: Location

Parameter Type: Input Output

Data Type: Number

Default Value: 20

Parameter Style: Slider Knob

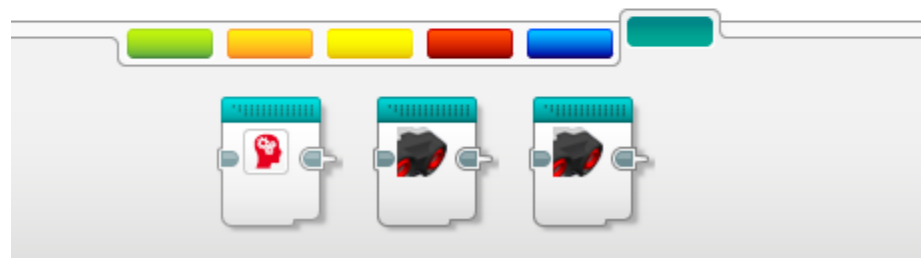
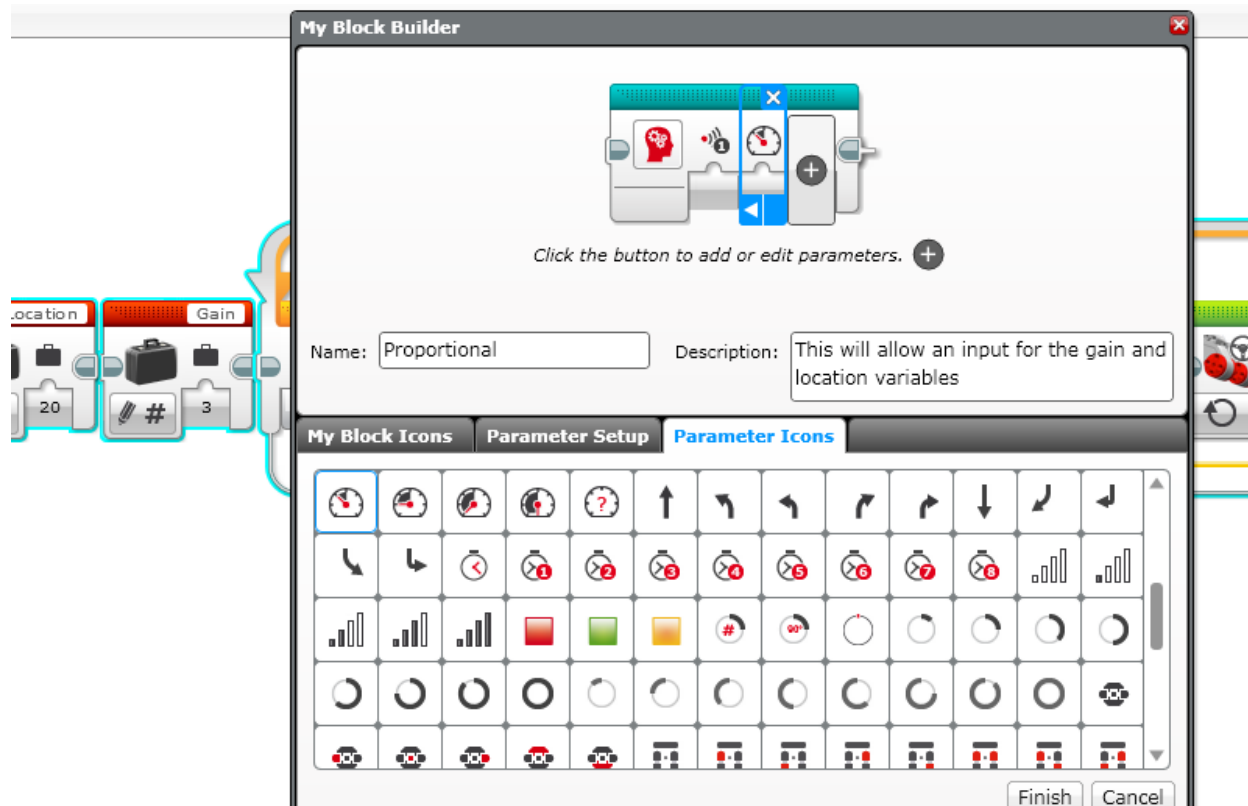

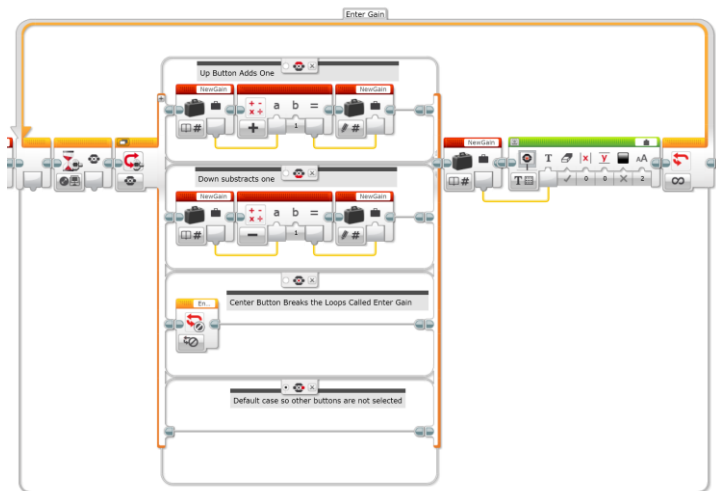
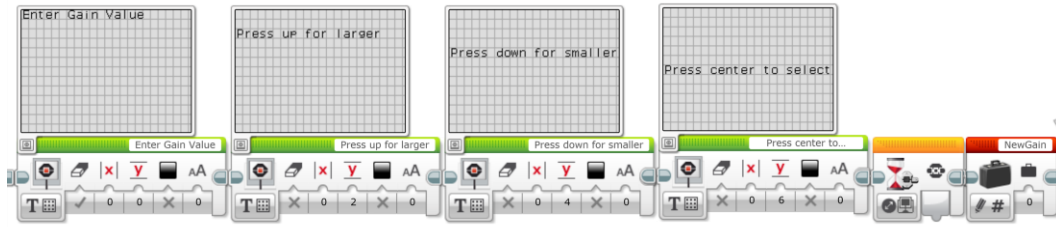
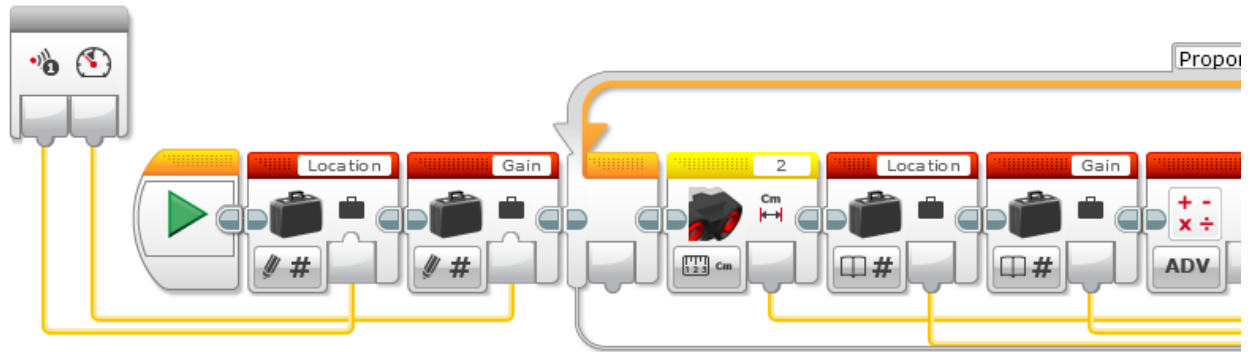

Enter Gain

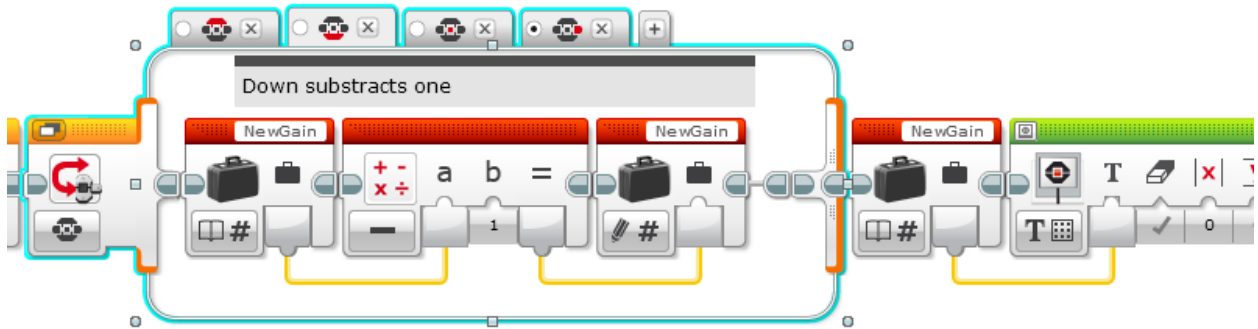

Enter Gain

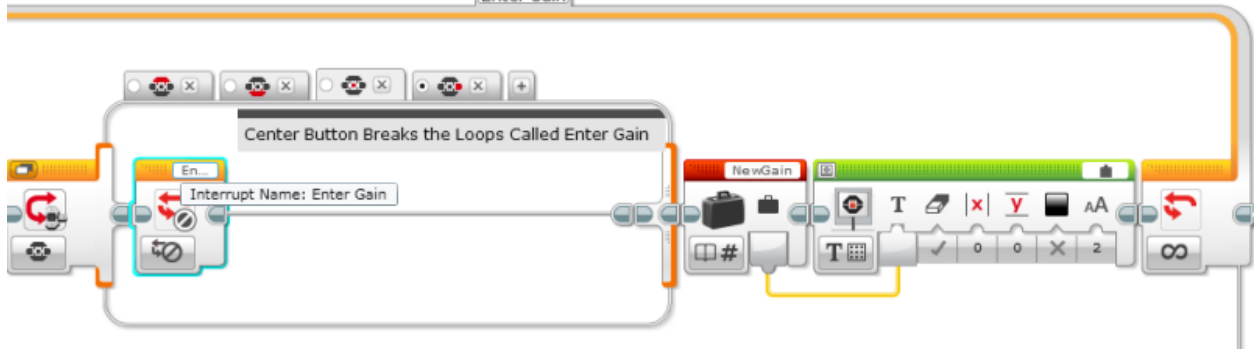

Enter Gain

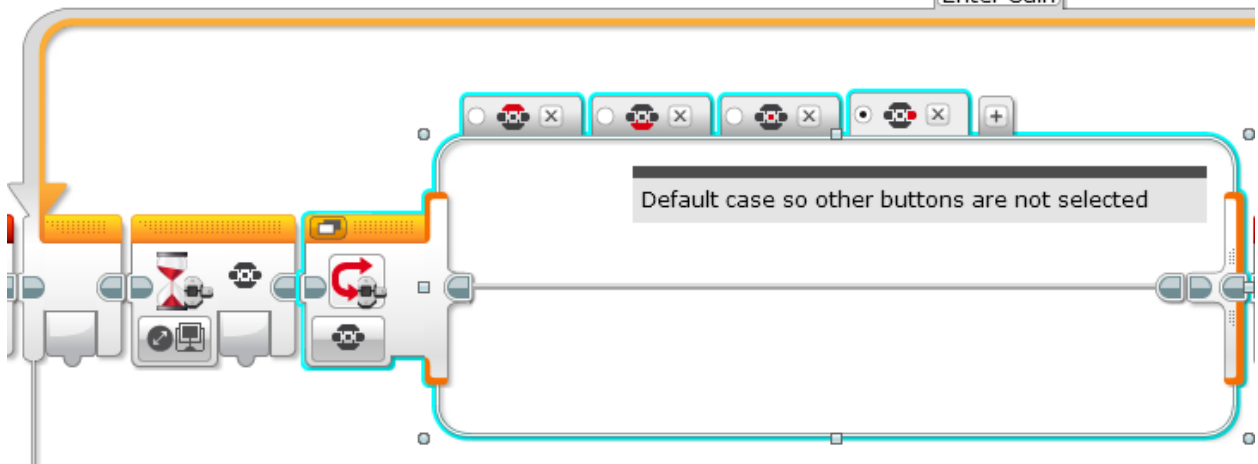

My Block Builder

Click the button to add or edit parameters.

Name: Description:

My Block Icons | **Parameter Setup** | **Parameter Icons**

Name:

Parameter Type: Input Output

Data Type:

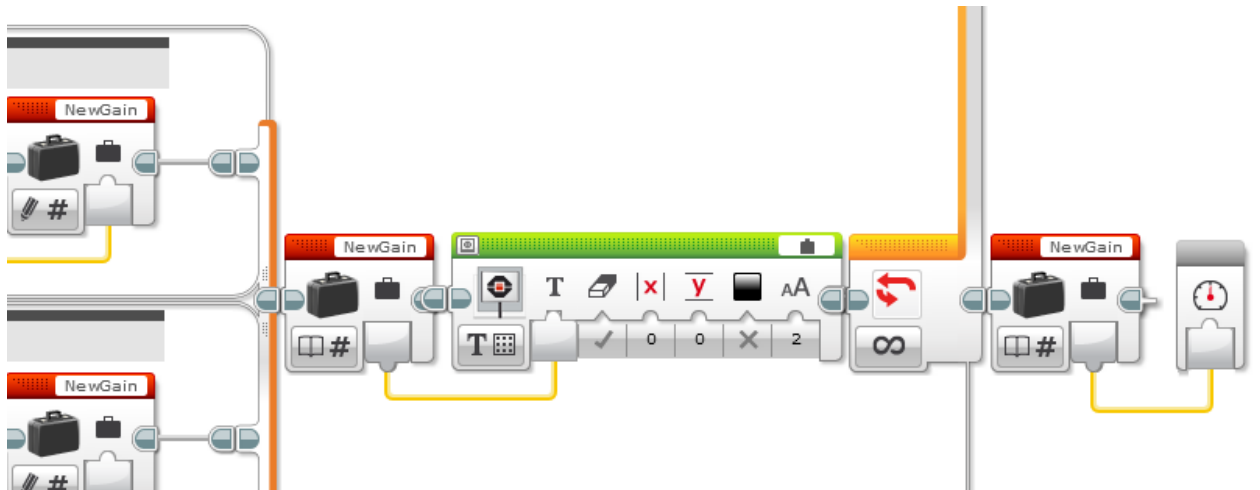

Enter Stop Distance Press up for farther Press down for less Press center to select Distance

Distance

Up Button Adds One

Distance

Down subtracts one

Distance

Center Button Breaks the Loop Called Distance

My Block Builder



Click the button to add or edit parameters. 

Name: Description:

My Block Icons | **Parameter Setup** | **Parameter Icons**

Name:

Parameter Type: Input Output

Data Type:

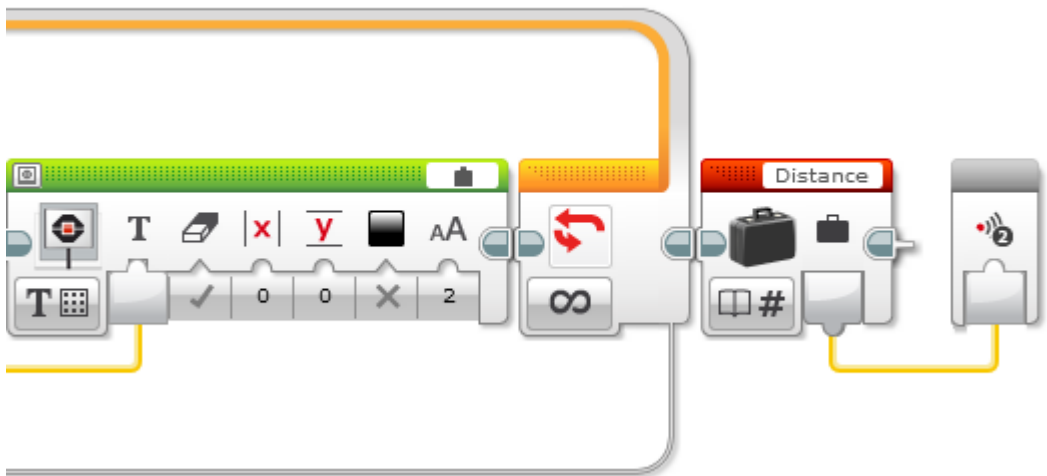

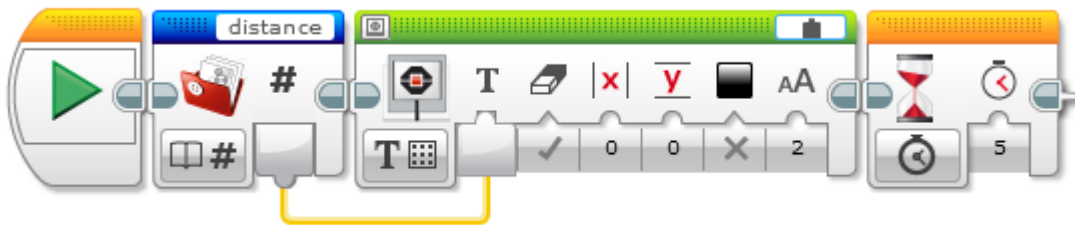
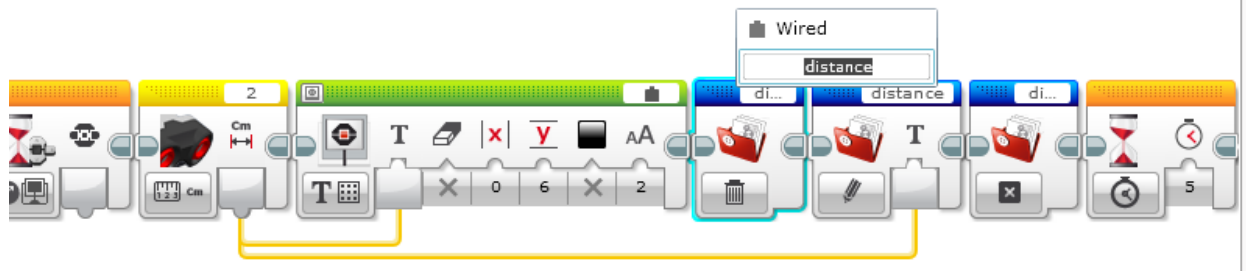
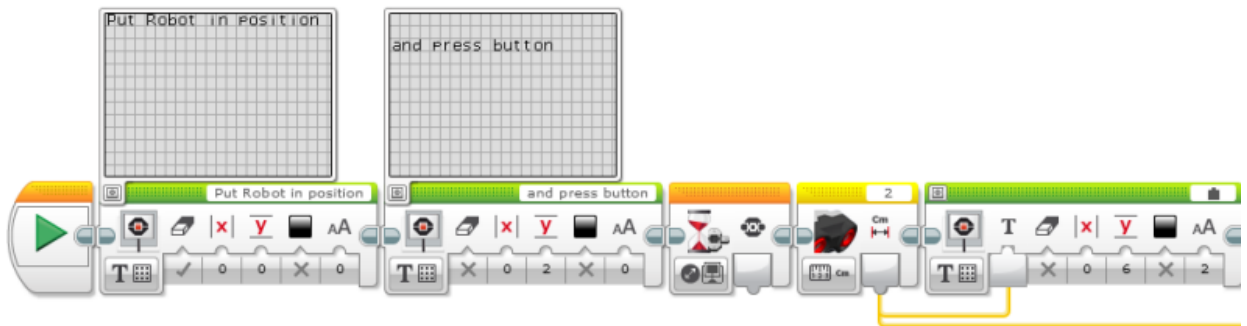
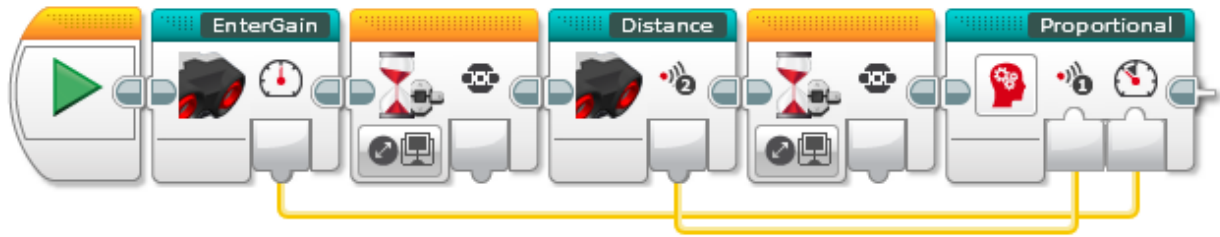

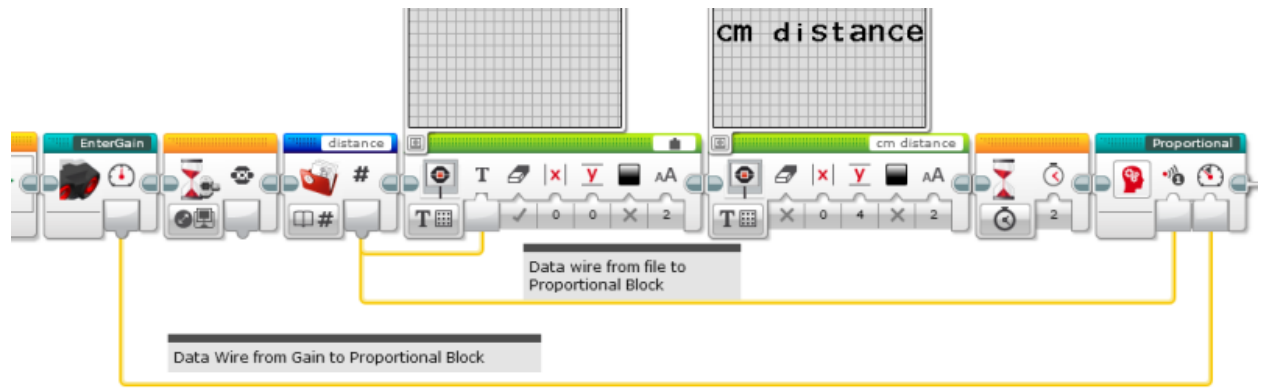

Proportional line follower (Advanced)

1

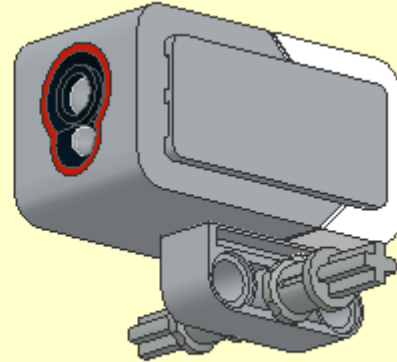
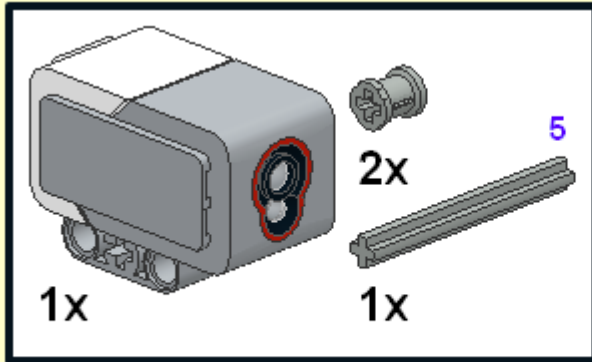

2

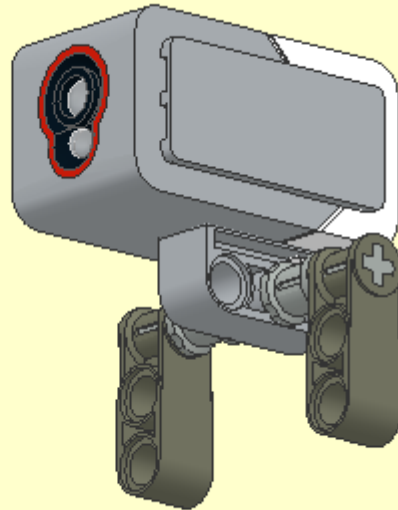

3

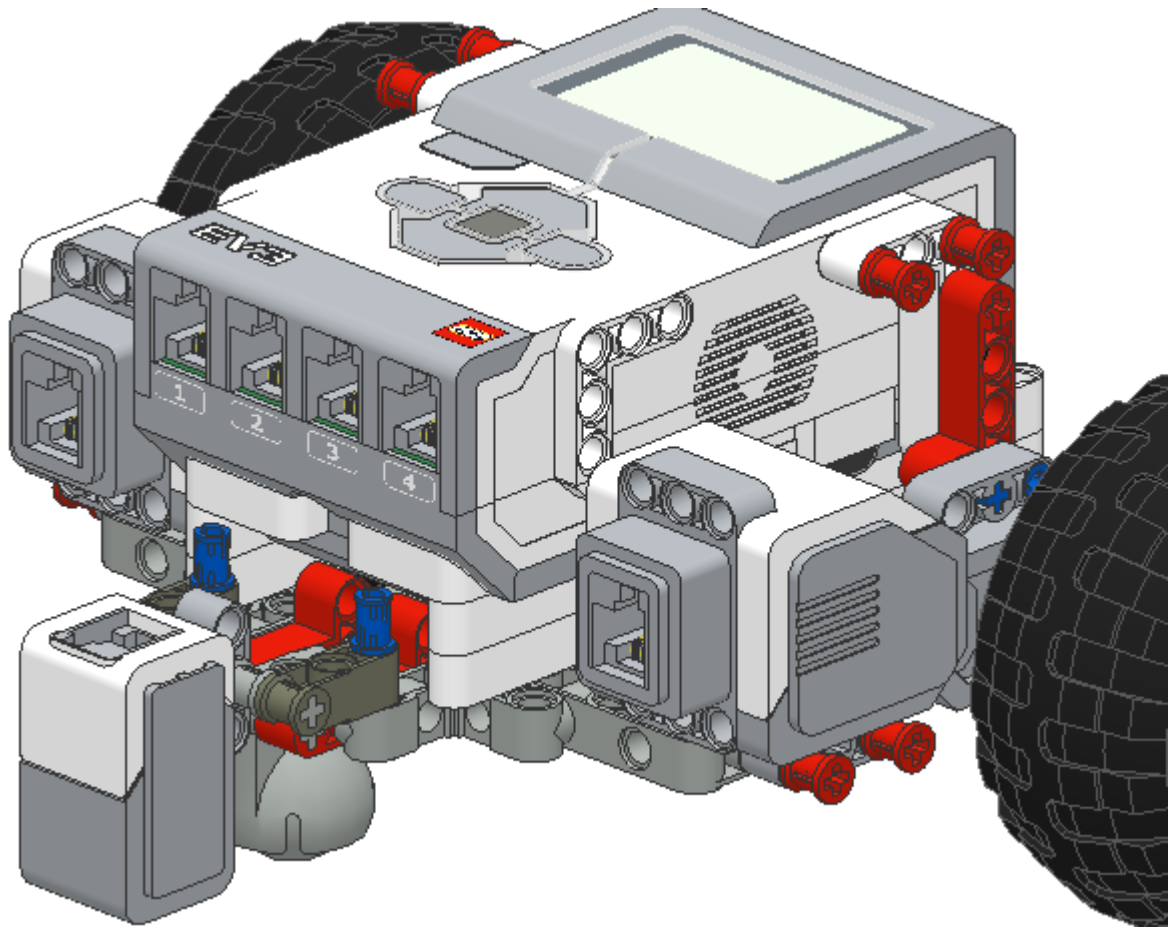
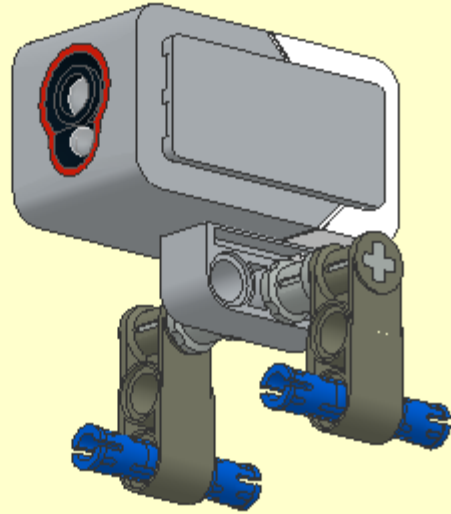

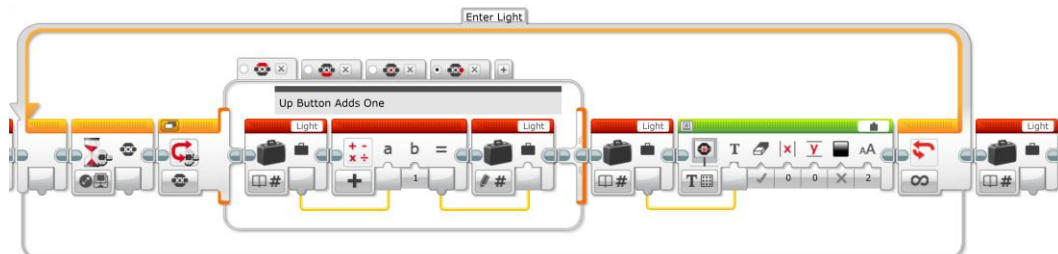
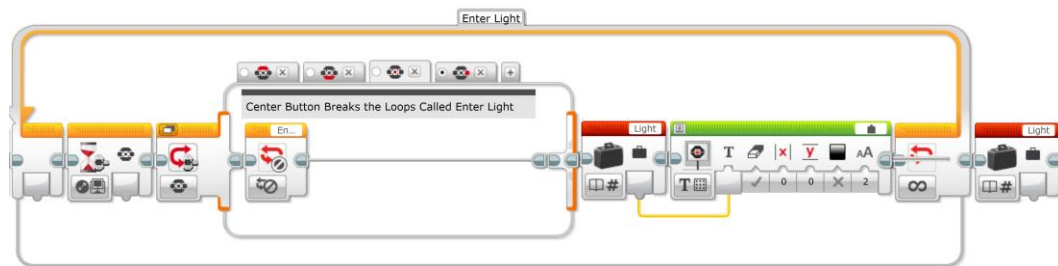
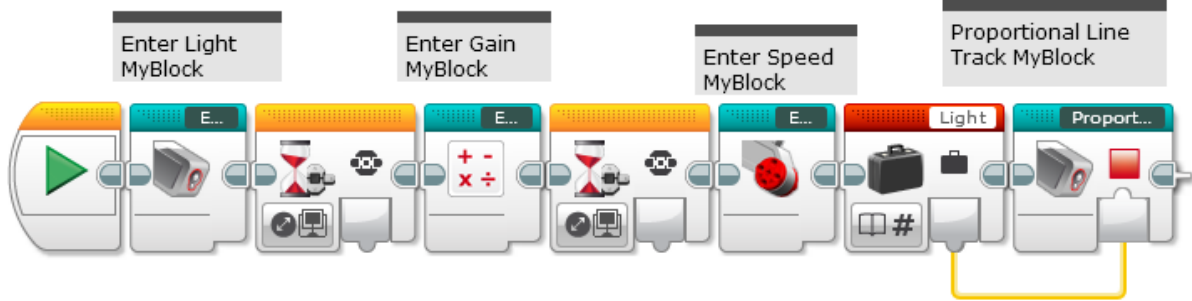
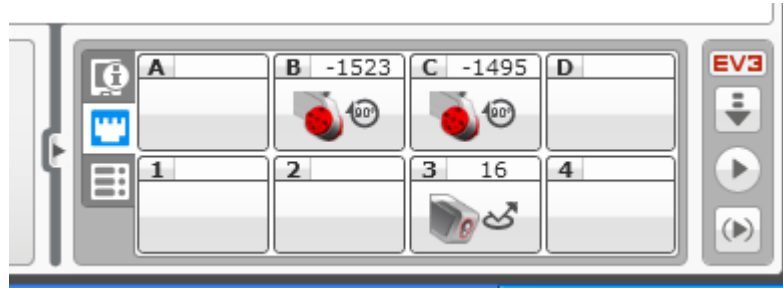
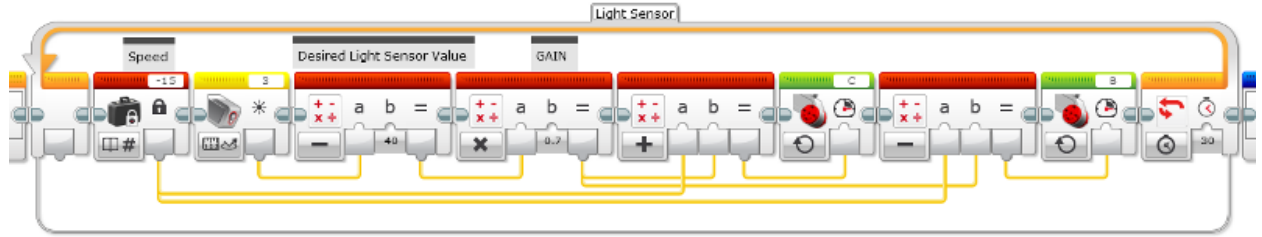

Enter Light

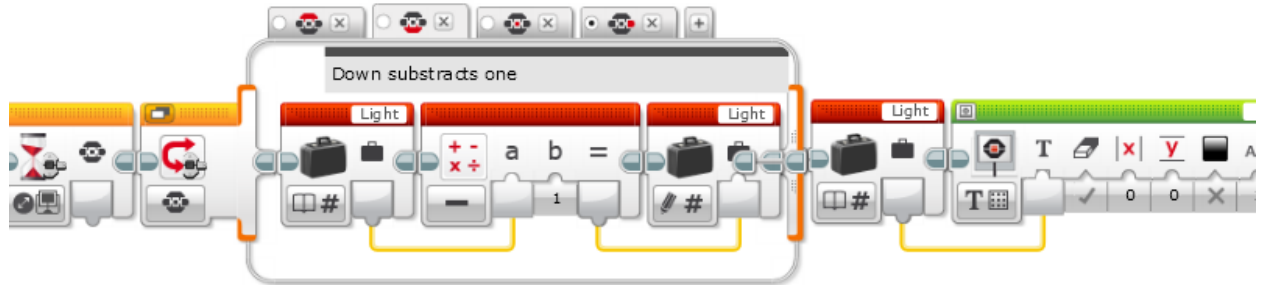

Enter Light

